

Midwest Suburban Baseball League

2



0

0

Manager's Guide Book

5

TABLE OF CONTENTS
for
MANAGERS' GUIDE BOOK

Calendar of Events
Board of Directors
By-Laws
Rules and Regulations
Field Requirements
Maps to Fields
Fines
Ineligible Player List
Form for Protest of Games
Player's Waiver and Consent Form
Player Notification Umpires and Fields Form
All-Star Game Information
Chicago North Tryout Information
Sponsorship Guide/Tips
Tournament Schedule
MSBL/MABL: President's Report Cap Cure Benefits Accident and Medical Coverage Insurance Coverage Notice of Liability Claim Form

Midwest Suburban Baseball League 2005 Board of Directors

MIDWEST SUBURBAN BASEBALL LEAGUE

League Office
P.O. Box 191
Batavia, IL, 60510

League Hotline
888-339-5585

2004 BOARD OF DIRECTORS

President Lawrence Kolcz 773-430-7979		Vice President Jason Yormark 847-293-0667	
Board Member AAA Jay Lopez 847-430-3125	Board Member AA Dave Bruchman 224-578-2427	Board Member A Dennis Lopez 773-396-2082	

Midwest Suburban Baseball League
By-Laws

1. Midwest Suburban Baseball League

- A. The organization shall be known as: Midwest Suburban Baseball League, a privately owned entity to provide a service in the form of organized baseball.

2. Notification

- A. The League's official mailing address shall be: P.O.Box 0191
Batavia IL 60510
- B. The Registered Agent and Registered Office to be filed with the Secretary of State of Illinois shall be:

Lawrence Kolcz
P.O.Box 0191
Batavia IL 60510

3. National Affiliation

- A. The League shall be affiliated with the national organization:

Men's Senior Baseball League, Inc.
One Huntington Quadrangle, Suite 3NO7
Mellville, NY 11747

4. Principles and Purposes of the League

- A. To provide the opportunity to play organized baseball for those 18 years of age and older.
- B. To promote a competitive environment and playing schedule.
- C. To encourage good sportsmanship among its players.

5. Eligibility

- A. Any team shall be eligible for affiliation if, and only if, all of its rostered players are at least 18 years of age by January 1 of the current year.
- B. The manager shall determine and assure the league that all his team's players are eligible.
- C. Provided it is still eligible and in good standing with the league, a team that was affiliated with the league in the prior year shall retain its affiliation for the current year.

Midwest Suburban Baseball League
By-Laws

6. Termination of Eligibility

- A. The manager shall have the authority to discipline players who demonstrate poor sportsmanship or compromise the principles and purpose of the league.
- B. Additionally, the President and Vice President, shall have the authority to discipline, suspend, or terminate the eligibility of any team, manager, or player. If the team, manager, or player is the subject of a complaint, the party shall receive notice of the complaint and be permitted to attend the meeting and respond to the charges.
- C. If a manager suspects an ineligible player, he may protest by notifying the President or Vice President within 24 hours of a completed game. If the player is found ineligible, the game just played, and any other games played by that player, will be forfeited. Additionally, the player will be suspended for at least one additional season. If the manager was aware of the violation, he too shall be suspended for the remainder of the season plus one additional season.
- D. A player's eligibility is terminated when:
 - He is removed from his team roster by his manager or by the President or Vice President.
 - His team's affiliation is terminated by President or Vice President.
 - His team resigns its affiliation.
- E. Appeal process through three League representatives

7. Expansion

- A. Any eligible team may apply in writing for affiliation with the League.
- B. New teams cannot use a team name that is currently being used by a team already affiliated with the League.
- C. The application shall be on an appropriate form provided by the League and will include signatures of ten eligible players. An application fee in the amount of \$500 will also be attached.
- D. If the application is:
 - Approved -- application fee will be credited toward the total team participation fee.
 - Rejected -- application fee will be fully refunded.
 - Withdrawn by the new team -- application fee is forfeited after March 1st.
- E. President or Vice President shall approve team applications for affiliation.

Midwest Suburban Baseball League
By-Laws

8. Duties and Responsibilities of the President and Vice President

The President and Vice President manage the MSL and their responsibilities include, but are not limited to the following:

- A. Establish a budget for League activities
- B. Collect fees from teams to fund the budget
- C. Arrange for facilities usage by its League membership
- D. Obtain insurance coverage
- E. Schedule league activities
- F. Provide a schedule for baseball team competition
- G. Provide for umpires to officiate scheduled games
- H. Coordinate the purchase of equipment for league operations
- I. Administer and enforce all rules and policies set forth in this publication
- J. Convene to hear all grievances, protests, and appeals

9. Duties and Responsibilities of the Managers

- A. Develop a team roster
- B. Develop a team budget
- C. Solicit team sponsorship
- D. Collect fees from players and forward to the league
- E. Represent players at league meetings and functions
- F. Determine and administer team policies
- G. Communicate and enforce league rules and regulations
- H. Schedule and supervise practices
- I. Obtain equipment and team uniforms
- J. Field management during and after games

Midwest Suburban Baseball League
By-Laws

10. Disqualification

- A. If a team has not paid its team participation fee by the second weekend in April, or any extension granted by the President and Vice President, the team shall be disqualified for play in the current year.
- B. The President and Vice President, at its sole discretion, may reinstate a disqualified team. To be eligible for reinstatement, the team must, prior to the start of the first regularly scheduled game, pay all team participation fees due plus a reinstatement fee of \$500.
- C. If a team is disqualified, all application and team participation fees paid through the date of disqualification shall be forfeited.

11. Rosters

- A. Each roster will include the following information:
 - First and last names
 - Residence street address, city and zip code
 - Day and evening telephone numbers
 - Date of birth
 - A player waiver form for each player
 - Umpire and Field Waivers
- B. The manager will deliver a preliminary roster by opening day.
- C. The manager may add or delete eligible players to the roster by notifying the President and/or Vice President not less than 48 hours before a scheduled game.
- D. The roster in effect at the end of August 1st is the final roster in accordance with League Rule 3.2.
- E. After August 1st, a manager may add a player to the roster. This addition of names is subject to 48-hour prior notification and approval by the President and/or Vice President.
- F. No player shall be eligible for post-season play unless he has been rostered before August 1st and is compliant with the League Rule 3.3.

**Midwest Suburban Baseball League
By-Laws**

12. Refunds

- A. Games not played and not re-scheduled amount to TBD
- B. Missing umpires amount TBD
- C. Umpire fees in a forfeit situation, the forfeiting team pays

13. Miscellaneous

- A. Managers and players are not allowed to contact baseball coaches, athletic directors, or any other field personnel concerning fields without permission from the League. Violations of this by-law will result in termination.
- B. All inquires concerning any affiliation with the Midwest Suburban League is done through the President and Vice President.
- C. All inquires concerning general playing while the schedule is in progress, is done through your League representatives.
- D. League representatives can be voted on by Managers or appointed by the President or Vice President.



MIDWEST SUBURBAN BASEBALL LEAGUE
"chicagoland's largest amateur mens baseball league"

2005

RULES AND REGULATIONS GOVERNING THE MIDWEST SUBURBAN BASEBALL LEAGUE





RULES AND REGULATIONS GOVERNING THE MIDWEST SUBURBAN BASEBALL LEAGUE

The Midwest Suburban League (MSL) was established March 1998. The MSL is affiliated with the Men's Senior Baseball League (MSBL) and the Men's Adult Baseball League (MABL). The MSBL was produced to provide baseball for men 30 years old and over, and 40 years old and over. The MABL was produced to provide baseball for men 18 years old and over. The MSL provides baseball for men 18 years old and over, including men who are 30, 40, and 50 years of age.

The Midwest Suburban League endorses the MSBL/MABL philosophy that adult attitudes must always prevail, no matter how competitive any league is. Furthermore, the responsibility that this ethic sustains will remain the responsibility of our league officers. Anyone who abuses the League's code can be suspended or expelled from it.

The President and Vice President manage the MSL. Their responsibilities include, but are not limited to the following:

- A. Establish a budget for League activities
- B. Collect fees from teams to fund the budget
- C. Arrange for facility usage by its League membership
- D. Obtain insurance coverage
- E. Schedule League activities
- F. Provide a schedule for baseball team competition
- G. Provide for umpires to officiate scheduled games
- H. Coordinate the purchase of equipment for League operations
- I. Administer and enforce all rules and policies set forth in this publication
- J. Convene to hear all grievances, protests, and appeals

The 2003 Board of Directors is composed of the following members:

- Larry Kolcz,
- Jason Yormark,
- Jay Lopez
- Dave Bruchman
- Dennis Lopez



GENERAL INDEX

Part	Rule	Pg
1	Uniforms, Helmets, Baseballs, Bats and Cleats	6
2	Game Length, Run Rule, Rain-Outs, and Suspended Games	7
3	Team Eligibility, Team Rosters, and Player Eligibility	10
4	Line-ups	11
5	Player's Behavior and Team Responsibility	14
6	Special Rules: Courtesy Runners, Pitchers, and Fielders	16
7	Ex-Pro Status and Regulations	18
8	General League Rules	19
9	Code of Conduct	20
10	Grievances, Protests, and Appeals	22

SECTION INDEX

Sec	Rule	Pg
1	Uniforms, Helmets, Baseballs, Bats and Cleats	6
1.1	Uniforms	6
1.1.a	Out of Uniform	6
1.1.b	Team Uniform Deadline	6
1.1.c	Grace Period for Uniforms	6
1.2	Helmets	6
1.3	Baseballs	7
1.4	Cleats	7
1.5	Bats	7
1.5a	Wood Bat League	7
1.5b	All Other Leagues	7
2	Game Length, Run Rule, Rain-Outs, and Suspended Games	7
2.1	Game Length and Time Between Games	7
2.1a	Game length	7
2.1b	Time Limits 9-Inning Game	7
2.1c	Time Limits 7-Inning Game	7
2.1d	Extra Innings	7
2.1e	Time between games	7
2.2	Abbreviated Games	8
2.2a	Darkness	8
2.2b	Lights Out	8
2.2c	Rain	8
2.2d	Run-Rule	8
2.3	Exceptions to Abbreviated Games	8
2.3.a	Play-offs	8
2.3.b	Darkness	9



Sec	Rule	Pg
2.4	Make-up of Rainouts and Suspended Games	9
3	Team Eligibility, Team Rosters, and Player Eligibility	10
3.1	Team Eligibility	10
3.2	Team Rosters	10
3.3	Play-off Roster	10
3.4	Player Eligibility	11
3.4.a	Waivers	11
3.4.b	Changing Teams	11
3.4.c	Players Forming New Teams	11
4	Line-ups	11
4.1	Line-up Cards	11
4.2	Notice of Line-up Substitutions	11
4.3	Minimum Line-up	11
4.4	Minimum Number of Players	12
4.5	Maximum Line-up	12
4.6	Line-up Additions	12
4.7	Skipping Batters	12
4.8	Hitting and Defensive Line-ups	12
4.8.a	Effect of Injuries on Line-up	12
4.8.b	Effect of Ejections on Line-up	12
4.9	Defensive Substitution	12
4.10	Pitcher Re-entry	12
4.11	Re-entry Rule	13
4.12	A/B Line-up	13
5	Player's Behavior and Team Responsibility	14
5.1	Alcohol and Drugs	14
5.2	League Suspensions and Expulsions	14
5.3	Game Expulsions	14
5.4	Fighting and Physical Contact	14
5.5	Collision Rule	14
5.6	Adherence to Age Regulations	15
5.7	Non-Rostered Players	15
5.7.a	Picture Identification	15
5.7.b	Checking Identification	15
5.7.c	Opposing Manager's Rights	15
6	Special Rules: Courtesy Runners, Pitchers, and Fielders	16
6.1	Courtesy Runners	16
6.2	Catcher Courtesy Rule	16
6.3	Pitcher's Clothing	16
6.4	Pitcher's Wildness and Player Safety	17
6.4.a	Pitcher Ejection	17
6.5	Fielder's Decoy and Player Safety	17



Sec	Rule	Pg
6.6	Borrowing a Player	17
6.7	Player Crossover Rule	17
6.7a	Designating Crossover Players	17
6.7b	Limitations on Crossover Players	17
6.7c	Violations of Crossover	17
6.8	Player Crossover Rule	17
6.9	Manager Crossover Rule	18
7	Ex-Pro Status and Regulations	18
7.1.1	Professional and Ex-Professional Ballplayers	18
7.1.2	Roster Limits on Ex-Professionals	18
7.1.2a	National League Divisions	19
7.1.2b	American League Divisions	19
7.1.2c	Central League Divisions	19
8	General League Rules	19
8.1	Team Forfeits	19
8.1.a	Forfeiting Team's Responsibility	19
8.1.b	Forfeit Limit	19
8.2	Protests	19
8.3	Fields	20
8.3.a	Home Team's Responsibilities	20
8.3.b	Visiting Team's Responsibilities	20
8.4	Drafts	20
9	Code of Conduct and Penalties	20
9.1	Code of Conduct	20
9.2	Penalties	22
10	Grievances, Protests, and Appeals	22
10.1	Grievances and Protests	22
10.2	Appeals	22



RULES

All rules for the Midwest Suburban League are as set forth in the 2003 Official Rules of Major League Baseball (American League Version) except as modified herein. The Management (i.e. President and Vice President) of the Midwest Suburban League have ratified these rules.

PART 1 - UNIFORMS, HELMETS, BASEBALLS, BATS, AND CLEATS

1.1 Uniforms - A team's players must have matching jerseys with individual numbers and matching hats. Pants must be baseball style, but need not match. Softball pants, jeans, cut-offs, and shorts are not acceptable. Teams having sponsorship will be allowed to have the sponsor's name on their uniforms via patch or uniform shirt.

(a) Out of Uniform - A player out of uniform will not be allowed to play without consent of the opposing manager unless rules 1.1(b) and 1.1(c) are in force.

(b) Team Uniform Deadline - All teams should have their uniforms by the beginning of the sixth week of the season.

(c) Grace Period for Uniforms - Additional grace periods for teams not in compliance at the end of deadline (Rule 1.1(b)) will be at the discretion of League's President or Vice President. It is the responsibility of each team's manager to make requests of the League management for extension of deadlines and for written documentation of approved extensions. Without written documentation of league approval of deadline extensions, the opposing manager may impose **Rule 1.1(a)** whereby the opposing manager can choose to give or not give consent for the player(s) out of uniform.

i. If there are problems meeting the deadline, the team's manager must obtain any additional grace period granted by the league in writing and present it to the opposing team's manager; otherwise, Rule 1.1(a) is in effect.

ii. If requested by the manager, properly registered, newly activated players obtained during the course of the season are granted a grace period for obtaining a proper uniform. In this case, League management will issue a note to the affected team's manager indicating the expiration of the grace period. The affected team's manager must present the note to the opposing manager to avoid penalty from **Rule 1.1(a)**.

1.2 Helmets - All batters and runners must wear helmets during all at-bats, while in the on-deck circle, and while on the bases or base-paths. Full double earflap helmets are encouraged. Catchers are also encouraged to wear a helmet underneath their mask.



1.3 Baseballs - Each team shall remit two baseballs to the umpire at the beginning of each game. The following baseballs are approved for use:

- Rawlings: RO-MSBL, RCC-MSBL, R-100 MSBL, RCC-MABL, R-200, RO, RO-A, RO-N, RRHS, and 05R200B
- Baden: 3B-B Pro and 2BB HS
- Diamond D1, DHS, DOLA
- Wilson 1010C, A1040, A1010

1.4 Cleats - Metal cleats are permitted. Any player found to be wearing deliberately sharpened cleats would be subject to ejection and possible suspension from the league.

1.5 Bats

- (a) **Wood Bat Leagues** – Only wood bats conforming to Rule 1.10 (a), (b), and (c) of the 2003 Rules of Major League Baseball are allowed.
- (b) **All Other Leagues** – Only wood and metal bats conforming to the applicable specifications of Rule 1.10 (a), (b), and (c) of the 1997 Rules of Major League Baseball are allowed. Additionally, bats shall have no greater than a -5 ounce drop.

PART 2 - GAME LENGTH AND TIME BETWEEN GAMES, RUN RULE, DARKNESS, SUSPENDED GAMES, AND RAINOUTS

2.1 Game Length and Time Between Games

- (a) **Game length** - All games are 9 innings in length except for the second game of a doubleheader, which is 7 innings in length.
- (b) **Time Limits 9-Inning Game** - All 9 inning games have a three-hour time limit. No inning shall start after the three-hour limit. Any inning in progress after the three-hour limit shall be completed; however, if the Home Team is ahead, the game is complete after the half inning.
- (c) **Time Limits 7-Inning Game** - All 7 inning games have a 2.5-hour time limit. No inning shall start after the 2.5-hour limit. Any inning in progress after the three-hour limit shall be completed; however, if the Home Team is ahead, the game is complete after the half inning.
- (d) **Extra Innings (Ties)** - Extra innings must be played to break a tie regardless of time limits.
- (e) **Time Between Games** - The second game of a doubleheader starts no less than 30 minutes after the first game has ended. May be less than 30 minutes if agreed upon by both managers and the umpire.



2.2 Abbreviated Games - The umpire may suspend, cancel or call a game if, in their opinion, the safety of the players is compromised due to rain, darkness or time limits.

(a) **Darkness** – If the game is judged by the umpire to be unplayable due to darkness:

- The standard 9-inning game will be considered complete at the end of 7- innings and 6 ½ innings when the home team is ahead.
- The standard 7-inning game will be considered complete at the end of 5- innings and 4 ½ innings when the home team is ahead.

If the game is called prior to completion, the game is considered suspended. When rescheduled, the game shall pick up precisely where it was left off.

(b) **Lights Out** – If the game is interrupted due to field lights going out:

- The standard 9-inning game will be considered complete at the end of 7- innings and 6 ½ innings when the home team is ahead.
- The standard 7-inning game will be considered complete at the end of 5- innings and 4 ½ innings when the home team is ahead.

If the game is called prior to completion, the game is considered suspended. When rescheduled, the game shall pick up precisely where it was left off.

If the interruption of the game occurs in any portion of an inning, the score reverts back to the last completed inning.

(c) **Rain** - If a standard 9-inning or standard 7-inning game is judged by the umpire to be unplayable due to rain, the game will be considered complete at the end of 5-innings and 4½ innings when the home team is ahead. If the game is called prior to completion of 5 innings, or 4½ innings when the home team is ahead, the game is considered cancelled and will be made up in accordance with the rainout policy.

(d) **Run-Rule** - The game will be ruled final if there is a 10-run discrepancy at the end of 7 innings. This rule will not pertain to 7 inning games. This rule will not pertain to league playoff games.

2.3 Exceptions to Abbreviated Games –

(a) **Playoffs** - All league playoff games must be played to completion (i.e. Standard 9-innings and extra innings to break a tie).

2.3 Exceptions to Abbreviated Games – (Continued)

(b) Play-off Games and Darkness – Play-off games affected by darkness where 9-innings have not been completed shall be suspended and played to completion of 9 innings when the game is made up. The game shall pick up precisely where it was left off. If they are present, each team must use players in the same place in the line-up. Substitutions can only be made for absent players. Players previously removed from the game can only re-enter under the re-entry rules.

2.4 Makeup of Rainouts and Suspended Games – The baseball season is split into three sections; the following holidays are the dividers: Memorial Day, July 4th, and Labor Day. If you have any rainouts/suspended games that have occurred before either of the following holidays: Memorial Day, Independence Day, or Labor Day, the games must be made up on, or before, that holiday. Games will be made up according to the following schedule:

Holiday	Central League	American League	National and Wood Bat League
Memorial Day	Saturday, May 28	Sunday, May 29	Monday, May 30
Independence Day	Sunday, July 3	Monday, July 4	Saturday, July 2
Labor Day	Monday, September 5	Saturday, September 3	Sunday, September 4

Managers of teams affected by rainouts/suspended games may confer and agree upon other dates for make-ups; however, such dates are subject to approval by League management and must occur before or near to the appropriate holiday weekend serving as the divider. The League will not tolerate pushing too many games to the end of the season. There are insufficient fields to accommodate this type of backlog.

Make-ups of any rainout/suspended games that have not been scheduled by agreement between managers will be schedule by the League according to the schedule in the above Table. The games will be added according to this schedule as events occur. For example, teams that are rained out will be rescheduled by the League according to the plan delineated in the Table. This will occur on a week-to-week basis. Games not made up according to this schedule will not be rescheduled until all current rained-out/suspended games are schedule according to this plan.

Example: A rainout occurs on April 25th affecting three AAA games, four AA games and three A-games:

- 1.) AAA - Ravens vs. the Stingrays
- 2.) AAA - Lookouts vs. Hi-Tops
- 3.) AAA - Lugnuts vs. Mudcats
- 4.) AA - Redhawks vs. Cubs
- 5.) AA - Thunder vs. Storm
- 6.) AA – Swingers vs. Scrappers



2.4 Makeup of Rainouts and Suspended Games – (continued)

- 7.) AA – Vipers vs. Dodgers
- 8.) A – Blues vs. Aeros
- 9.) A – Orbitz vs. Rockies
- 10.) A – Punishers vs. Tigers

The League would schedule these games accordingly:

Saturday May 29	Sunday May 30	Monday May 31
Blues vs. Aeros	Redhawks vs. Cubs	Ravens vs. the Stingrays
Orbitz vs. Rockies	Thunder vs. Storm	Lookouts vs. Hi-Tops
Punishers vs. Tigers	Swingers vs. Scrappers	Lugnuts vs. Mudcats
	Swingers vs. Scrappers	

Games not made up due to the lack of effort by a given team will be judged a forfeit and a \$150 fine will be imposed. If you have attempted to reschedule the games and no facilities are available, and the season runs out, your money will be refunded for that game. However, your money will only be refunded if every attempt has been made by your team to reschedule within the timeframes given.

PART 3 - TEAM ELIGIBILITY, TEAMS ROSTERS, AND PLAYER ELIGIBILITY

3.1 Team Eligibility - Team rosters, league fees, MABL/MSBL affiliation fees, proof of date of birth of all players, player waiver forms, and team medical forms must be submitted to the league by opening day

3.2 Team Rosters - Final team rosters must have no less than 15 players. Rosters may not be changed after August 1, 2004 except for the following reasons:

- A player(s) is lost to injury for the remainder of the year.
- A player from the roster voluntarily quits for the remainder of the season
- The League decides to extend dates for final rosters

3.3 Play-off Rosters - Players added to the roster after August 1, 2003 are not eligible for playoff and championship games unless approved by the League. In order for a player to qualify and participate in playoffs, tournaments, and post-season events, he must participate in at least 40% of his team's regular season games. If such a player fails to meet the requirements due to injury, a letter should be submitted to the league explaining non-compliance.



3.4 Player Eligibility - A player is eligible to participate in an official league sanctioned game on the date of their 18th birthday. Players under the age of 18 years are not eligible.

- (a) **Waivers** - Prior to participating in a game, all players must have signed waiver forms, which have been placed on file with the League.
- (b) **Changing Teams** - No player may switch teams without the consent of both managers and the League Board of Directors. If this does not meet with approval, the player must sit out one calendar year from competition, from the last date of his playing, or re-enter the league's next draft, making himself available to any team for selection. In the event a team disbands during the season or at season's conclusion, all players with 3 years seniority in the league will become automatic free agents and will be permitted to play for any desired team. Players not having 3 years in the league will re-enter the draft. If a player is not invited back by his manager, he must be given his release so that he may go to the team of his choosing or re-enter the draft. If a player is invited back to play and he desires not to play for his former team and cannot be successfully traded, he must sit out one entire year or re-enter the draft, making himself available to all teams.
- (c) **Players Forming New Teams** - In the event a player wishes to leave his existing team and form a new team, he may do so. No other player can be taken from the existing team without the consent of the existing team's manager. No other players may be taken from any other team without the respective team manager's approval.
- (d) **Free Agency** - Players can declare themselves free agents the first week of November. To be eligible for this, players must register with the League during this week.

PART 4 – LINE-UPS

- 4.1 Line-Up Cards** - Each team is required to provide a lineup card to the opposing manager before the start of the game. As a minimum, the line-up card must list the players' first initial, last name, their number, and the position that the players are playing.
- 4.2 Notice of Line-up Substitutions** - Managers must notify the home plate umpire and the opposing team of all substitutions when they are made.
- 4.3 Minimum Line-up** - A team's manager must bat a minimum of ten players whenever ten or more players are available. If a team only has nine players available and therefore bats nine players, the opposing team may also choose to use a nine-man lineup regardless of how many players are available. Under these circumstances, the minimum line-up is nine players instead of ten throughout the game.



- 4.4 Minimum Number of Players** - A team must have a minimum of 8 players for an official game. If not, they may arrange to borrow a player per **Rule 6.5** or forfeit the game.
- 4.5 Maximum Line-up** - The manager may bat as many players as he desires as long as it is in compliance with Rule 4.3.
- 4.6 Line-up Additions** - A manager may add batters to the bottom of the lineup at any time. However, if a batter is pinch hit for or run for (except as described by the courtesy runner rule **Rule 6.1**) the player may not re-enter the game as a hitter, but may remain in the game as a fielder or pitcher.
- 4.7 Skipping Batters** - Batters cannot be deleted or skipped over, regardless of their batting position or when they were added during the game unless **Rule 4.6** is in force.
- 4.8 Hitting and Defensive Line-ups** - Each team has a hitting and a defensive line-up that are independent of each other. Players may play in either line-up or both.
- (a) **Effect of Injuries on Line-up** - If a player is forced to leave a game due to injury, a reserve player, not previously entered into the game as a hitter, must hit in the batter's place. If no reserve is present, the vacated spot in the lineup is skipped and all batters move up accordingly, with no penalty to the affected team.
- (b) **Effect of Ejections on Line-up** - If a player is forced to leave a game due to ejection from a game, a reserve player, not previously entered into the game as a hitter, must hit in the batter's place. If no reserve is present, the vacated spot in the lineup is not skipped and an out is recorded every time the ejected batter's spot comes up.
- 4.9 Defensive Substitution** - All players may be substituted for defensively, at any time, without affecting the players' offensive status in the line-up.
- 4.10 Pitcher Re-entry** - If the pitcher is removed from the game (i.e. removed from the defensive line-up as a pitcher), he may re-enter the game to pitch during the course of the game. **However, he is only allowed to re-enter as a pitcher one-time** during the course of the game. The removed pitcher may play any other position after being removed or no position at all. A pitcher that is removed from the defensive line-up becomes subject to **Rule 4.9** like any other defensive player.



4.11 Re-entry Rule – A starter in the batting order may be removed and substitute may bat in that player's place at any point during a game, so long as the starter has had one plate appearance. The starter may return to bat again, but only in the original spot in the order that he vacated and only after his substitute has had at least one plate appearance. Once removed, a substitute may not bat again.

Batters added to the line-up after the game has started in accordance with **Rule 4.6** may not re-enter the hitting line-up if they are pinch-hit for.

4.12 A/B Line-up

- (a) Prior to the start of play, at the time that lineups are exchanged, a team may declare that batting order positions from 9 up (i.e. 9, 10, 11, 12, etc.) will be occupied by two players in each such batting position (i.e. 9A/9B, 10A/10B, 11A/11B, etc). The first time that position 9 gets an at bat 9A would hit and the next time this slot hits, 9B would be up. Then 9A hits the third time this spot in the order comes up, and so on, alternating between these two players throughout the game.
- (b) Once a team declares the use of this A/B system, it must continue using it for the remainder of the game. A team using the A/B system may not make use of **Rule 4.6**; batters can not be added to the bottom of the line-up at any time during the course of a game.
- (c) In the event of an injury, and for which there is no replacement player, the effected A/B hitting position will be skipped over without penalty.
- (d) In the event of an ejection, and for which there is no replacement player, the effected A/B hitting position will not be skipped over and an out is recorded every time the ejected batter's spot comes up.

Hitters in the batting order from position 9 and down (i.e. the A/B positions) may be pinch-hit for or pinch-run for, just as any other player. However, if a batter is pinch hit for or run for (except as described by the courtesy runner rule **Rule 6.1**) the player may not re-enter the game as a hitter, but may remain in the game as a fielder or pitcher.



PART 5 – PLAYER’S BEHAVIOR AND TEAM RESPONSIBILITY

5.1 Alcohol and Drugs -Alcoholic beverages and illicit drugs are not permitted at the field before, during, or after the game. The field refers to the general playing area and ancillary areas.

5.2 League Suspensions and Expulsions - The league has the right to suspend or expel any team member who:

- Abuses league rules
- Does not exhibit an acceptable sense of sportsmanship
- Plays without regard to the safety of the umpires or other players.

5.3 Game Expulsions - An umpire has sole discretion to expel any player or manager from the game.

5.4 Fighting and Physical Contact - Fighting among players or aggressive physical contact with an umpire will not be tolerated. Players expelled from the game for either violation will be subject to suspension or expulsion from the league.

5.5 Collision Rule - Players shall not intentionally collide with any other players. In the case of a runner intentionally colliding with a fielder, the runner will be called out, and may, at the umpire’s discretion, be expelled from the game. All base runners must either slide or give up their right to a base (avoid a collision by stopping or leaving a base path) when the defensive player is in the following situations:

- Is in possession of the ball,
- Is in the act of receiving the ball, or
- Is about to immediately receive the ball and will be able to make an apparent play on the base runner.

If a defensive player is not in possession of the ball, is not in the act of receiving the ball, or is not about to immediately receive the ball so that he is able to record an out (apparent play...at any base), he cannot do the following:

- Block the base
- Be in the base path so as to impede (obstruct) the base runner's right to that base.

Under such circumstances, the defensive player shall be responsible to avoid collision. If a collision does occur under these circumstances, the runner will always be considered safe and the obstruction rule shall be enforced. The defensive player will be ejected from the game if the umpire judges the action intentional. The offending defensive player will be suspended from league play if the obstruction is judged to be flagrant.



5.6 Adherence to Age Regulations - The managers must all recognize their responsibility to the league, and the perpetuity of it, as to not cross the line where winning is more important than playing. An opposing manager has the right to question a player's age. If a manager wants to lodge protest, proof of age and residence must be given to the manager who lodged his protest by Friday of the following week. If an under age player is detected, penalties whether to the individual or team will be decided by the league board of directors. The penalties will be forfeiture of all games in which the under-age player participated in and a minimum two-year suspension. If the manager had prior knowledge, he is subject to similar suspension.

5.7 Non-Rostered Players -

- (a) Picture Identification - All players must have picture ID. Players without picture IDs are ineligible to play. A traffic ticket will be accepted as a form of ID.
- (b) Checking Identification - Checking IDs can take place during the course of a game and should not be done so as to delay the start of any game.
- (c) Opposing Manager's Rights - An opposing manager has the right to question if a player is rostered. If a manager wants to lodge protest, proof of the player's identity and residence must be given to the manager who lodged the protest immediately. If a non-rostered player is detected, the League Board of Directors, whether to the individual or team, will decide penalties. The penalty will be forfeiture of all games in which the non-rostered player participated. The team's manager is subject to suspension.



PART 6 – SPECIAL RULES: COURTESY RUNNERS, PITCHERS, AND FIELDERS

6.1 Courtesy Runners - Players that will need courtesy runners, must have their manager notify the opposing manager before game time. This is done by way of the line-up card. Whether in the starting line-up or not, players requiring a courtesy runner must be designated on the line-up card as non-runners (NR) at the time the line-up card is submitted. Players that are not in the starting line-up, but require the courtesy runner must be listed as a reserve (i.e. substitute) on the line-up card and designated as a non-runner (NR) prior to the start of the game. If the non-runner is not designated on the line-up card, the opposing manager may deny the courtesy runner.

Each team will be allowed the maximum of 2 courtesy runners per game. The player to make the last batted out must be the courtesy runner, unless if he is a non-runner also. In that event, the last batted out in sequential order shall be used. Once the game begins, and the full complement of two courtesy runners has not been used, only by obvious injury can an additional courtesy runner be used. In the event a player becomes injured during the game and the maximum number of courtesy runners (2) have already been designated, a pinch runner must be used and no courtesy runner will be allowed. If a batter (designated as needing a courtesy runner) opts to run, or forgets to get a courtesy runner and subsequently runs, he will lose his courtesy runner for that time on base only. Once a pitch is thrown, the batter designated as needing a courtesy runner loses his courtesy runner for that time on base only.

6.2 Catcher Courtesy Rule – A team may use a courtesy runner for the catcher after there are two outs in the inning. It is a courtesy runner; the catcher is not required to leave the game as in the case where a pinch runner is used. Runners used under this rule do not count toward the courtesy runner rule limits, but the last batted out rule remains in effect. The courtesy runner is the last batted out.

The catcher is identified as the last player who physically played that position on defense. In the top of the first inning only, the catcher is that player listed on the lineup as the catcher.

6.3 Pitcher's Clothing – While pitching, a pitcher may not wear the following:

- White or gray sleeves
- Batting gloves, or
- Wristbands.

Elbow supports worn for medicinal reasons must be black or flesh colored. The elbow support cannot be white, gray, or any other color that can be confused with the baseball.



6.4 Pitcher's Wildness and Player Safety – For the safety of the players, if a pitcher hits three batters in any one game, the pitcher must be removed after the third hit batsman. That pitcher can go out of the game or to any other playing position, but he may not re-enter as pitcher under **Rules 4.10 or 4.11**.

(a) Pitcher Ejection - If in the umpire's judgement a pitcher hits a batter intentionally he may eject the pitcher from the game. The offending pitcher is subject to further disciplinary action by the league.

6.5 Fielder's Decoy and Player Safety - Infielders are not allowed to decoy a throw or catch. If a decoy throw or catch is detected, all runners shall be allowed to advance one base beyond the base held after all play stops. If the same fielder decoys twice in the same game, the fielder shall be expelled from the game. Decoying is referred to as a false catch or throw done in an attempt to get the player to slide unnecessarily.

6.6 Borrowing a Player – A team may borrow up to two players (or more with League approval) from an opposing team in the League if they are unable to field a complete team (i.e. nine players) from their own roster. The borrowed players must play the outfield and bat eighth and ninth in the order (ninth if only one player). If the team's 8th and or 9th player arrives after the start of the game they are not eligible to play; the borrowed player must be used.

6.7 Borrowing a Player – A team may borrow up to two players (or more with League approval) from an opposing team in the League if they are unable to field a complete team (i.e. nine players) from their own roster. The borrowed players must play the outfield and bat eighth and ninth in the order (ninth if only one player). If the team's 8th and or 9th player arrives after the start of the game they are not eligible to play; the borrowed player must be used.

6.8 Player Crossover Rule – A player can play on two separate teams as long as they are in separate and succeeding Leagues with the following exceptions:

(a) Designating Crossover Players - All crossover players must register with the League before initiation onto a second team.

(b) Limitations on Crossover players

- All crossover players must designate their primary team for pitching purposes.
- Once designated, crossover players cannot switch teams thereafter during the season.
- Teams may also not designate more than two players during the course of the season.

(c) Violations of Crossover - The Board of Directors will rule on violations of the crossover rules. Penalties may include suspensions, game forfeiture, and loss of crossover stature.



6.9 Manager Crossover Rule – Any manager who manages a team in the MSL is entitled to play on that team.

PART 7 - EX-PRO STATUS AND REGULATIONS

7.1.1 Professional and Ex-Professional Ballplayers -

- (a) Eligibility of Professional Players - Professional-baseball player are not eligible to join teams competing in the MSL.
- (b) Eligibility of Ex-Professional Players - A player must be out of professional-baseball for 3 complete MSL seasons before becoming eligible to participate in the MSL.
- (c) Definition of Professional Players - Professional-baseball refers to any form of baseball where the players have been, or are being, paid, or compensated in any way, to play baseball. Forms of compensation include, but are not limited to, the player receiving gifts for playing, the player having his/her player fees waived in compensation for playing, the player receiving any form of remuneration for playing baseball.
- (d) Exceptions - A player is not an ex-professional baseball player if:
 - (1) The player is over 40 years old and he has been out of professional-baseball for at least 5 complete seasons.
 - (2) The player has been out of professional-baseball for more than 8 years.
 - (3) If he/she has played exclusively in the Independent Leagues

7.1.2 Roster Limits on Ex-Professionals - The ex-professional baseball players rules will be applied to League Divisions as follows:

(a) National League Divisions

- (1) No team may have a professional baseball player on its roster.
- (2) No team may have more than 3-ex-professional baseball players on their roster and no more than 25% of any team roster can be comprised of ex-professional baseball players, no matter the time spent out of professional-baseball.
- (3) No ex-professional baseball player may play, unless if he/she satisfies rule 7.1.1 (d) unless authorized with written permission from MSBL-National Rules Committee.



(b) American League Divisions

- (1)** No team may have a professional baseball player on its roster.
- (2)** No team may have more than 2-ex-professional baseball players on their roster and no more than 20% of any team roster can be comprised of ex-professional baseball players, no matter the time spent out of professional-baseball.
No ex-professional baseball player may play, unless if he/she satisfies rule 7.1.1 (d) unless authorized with written permission from MSBL-National Rules Committee.

(c) Central League Divisions

- (1)** No team may have a professional baseball player on its roster.
- (2)** No team may have more than 1-ex-professional baseball players on their roster and no more than 15% of any team roster can be comprised of ex-professional baseball players, no matter the time spent out of professional-baseball.
- (3)** No ex-professional baseball player may play, unless if he/she satisfies rule 7.1.1 (d) unless authorized with written permission from MSBL-National Rules Committee.

PART 8 - GENERAL LEAGUE RULES

8.1 Team Forfeits – A forfeited game occurs when one team is unable to field enough players at game time. A grace period of 15 minutes is allowed. The grace time-period time will count towards the time limit.

- (a)** Forfeiting Team's Responsibility - The forfeiting team is responsible for paying the umpires.
- (b)** Forfeit Limit - Two forfeits by any team could mean immediate expulsion from the League with no money refunded to the team. The League Board of Directors will make the decision on expulsion and monetary refund after hearing the affected team's appeal.

8.2 Protests -

- (a)** Managers (or acting managers) must file their "game-specific" protest (initially with the umpire) at the time of the incident, or at the time the incident becomes known to the manager (or acting manager), but before completion of the game. Game specific protests may not be made after the game is completed unless it involves the last play of the game.



8.2 **Protests** – (continued)

- (b) Game specific protests should be subsequently lodged with the League Board of Directors within 48-hours after the game for which the protest is made. The League Board of Directors shall render a ruling on all protests.
- (c) All other protests should be subsequently lodged with the league board of directors within 48-hours after the game for which the protest is made. The league board of directors shall render a ruling on all protests.

8.3 **Fields** – Participating teams are responsible for all pre-game and post-game maintenance. Failure to comply will result in disciplinary action by the league.

- (a) Home Team's Responsibilities - The home team will rake and drag the entire infield surface cutout excluding the mound and home plate area. In addition the home team will police its own dugout making assurances it is free of trash.
- (b) Visiting Team's Responsibilities - The visiting team will rake and drag the home plate and mound areas and the base paths between home and first base and between home and third base. In addition the visiting team will police its own dugout and spectator areas making assurances it is free of trash

8.4 **Drafts** - Each year, all players on the league's waiting list will be invited to a draft. The annual draft will be conducted in a manner to allow parity in leagues by having the prior year's teams with the lowest finishing records drafting first.

PART 9 - CODE OF CONDUCT AND PENALTIES

9.1 **Code of Conduct** - Managers and players shall conduct themselves in a sportsmanlike manner at all times. No manager or player shall commit the following:

- (a) Forcefully lay a hand upon, shove, strike, or threaten an official. Players and managers guilty of such conduct shall be immediately suspended from further participation in the game and shall remain suspended until the league board of directors reviews his conduct. Players and managers guilty of such conduct shall be subject to suspension for the remainder of the season or expulsion from the league for life.
- (b) Refuse to abide by an official's decision. Players guilty of such conduct shall be immediately suspended from further participation in the game and shall remain suspended until the league board of directors reviews his conduct. Players guilty of such conduct shall be subject to probation or suspension for the remainder of the season.



9.1 Code of Conduct – (continued)

- (c) Be guilty of objectionable demonstrations or objectionable dissent at an official's decision. Players and managers guilty of such conduct shall be subject to suspension from further participation in the game.
- (d) Discuss with an official, or officials the decision reached by such official or officials, except for the manager or his designee who are authorized to participate in such discussions. Players guilty of such conduct shall be subject to suspension from further participation in the game.
- (e) Use unnecessarily rough tactics in the play of the game against the body or person of an opposing player. Players guilty of such conduct shall be immediately suspended from further participation in the game and shall be subject to probation or suspension for the remainder of the season.
- (f) Be guilty of physical attack as an aggressor upon any player, manager, official, or spectator, before, during, or after a game. Players guilty of such conduct shall be immediately suspended from further participation in the game and shall remain suspended until the board of directors reviews their conduct. Players guilty of such conduct shall be subject to suspension for the remainder of the season or expulsion from the league for life.
- (g) Be guilty of an abusive, verbal attack upon any player, manager, official, or spectator before, during, or after a game. Players guilty of such conduct shall be immediately suspended from further participation in the game and shall remain suspended until the board of directors reviews their conduct. Players guilty of such conduct shall be subject to suspension for the remainder of the season.
- (h) Consume alcoholic beverages or illegal drugs during the game or be upon the field of play at any time in an intoxicated condition. Players guilty of such conduct shall be immediately suspended from further participation in the game and shall be subject to probation or suspension for the remainder of the season.
- (i) Smoke on the field of play or in the dugout. Players guilty of such conduct shall be immediately suspended from further participation in the game.



9.2 Penalties

- (a) The board of directors may, by vote of the majority of the directors, suspend any player or manager for such a period and upon such terms as it may propose, for the conduct within its opinion is prejudicial to the welfare, interest, reputation, or charter of the league.
- (b) Except as otherwise provided, the board of directors, or their commission, shall determine the appropriate action required for violations of the codes of conduct, and shall report their decision to the player and manager.
- (c) A player found in violation of any provision delineated in the codes of conduct, after being placed on probation for the remainder of the season shall be suspended for the remainder of the season.
- (d) Any player found in violation of any provisions delineated in the codes of conduct, after being suspended from further participation in a game shall be suspended for the remainder of the season.

PART 10 - GRIEVANCES, PROTESTS, AND APPEALS

- 10.1 **Grievances and Protests** - Grievances or protests may be filed by an individual player or by the manager of a team provided that a grievance is formally submitted to the board of directors. The board of directors shall adjudicate all such grievances.
- 10.2 **Appeals** - An appeal of any action or ruling may be filed with the board of directors by an individual player or by the manager of a team provided that the appeal is formally submitted. However, all decisions by the board of directors of an appeal are final and not subject to a re-appeal.

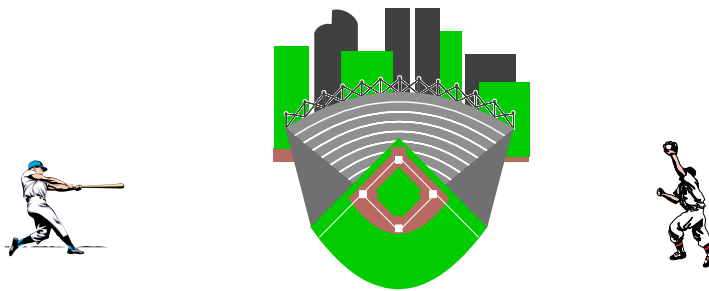

**Midwest Suburban Baseball League
Field Requirements**

FIELD	RULES
All Fields	<ol style="list-style-type: none"> 1. Lock box number for all fields is 123098 2. Trash pickup in dugouts and stands. 3. No smoking, no tobacco chewing, no alcohol, and no drugs on or near fields or parking lots or associated properties. 4. No warm-ups between the bases, warm-ups in the outfield only. 5. No short toss into the fences, 6. No climbing of fences, 7. No damage of any kind, 8. No relieving yourself any where on property except approved facilities, 9. Do not attempt to fix a wet field. [see fines]
Stadiums	The fields are the only facility you may use, no batting cages, no pitching machines, no throwing screens etc. You will be watched at these facilities.
Alexian Brothers Field	Trash pickup; remember “stadium rules”.
Barrington	<p>THIS FACILITY WAS SET UP BY ONE OF OUR OWN!!!!SPECIAL CARE OR ELSE!!!</p> <ol style="list-style-type: none"> 1. LOCK BOX LOCATED IN THIRD BASE DUGOUT NEXT TO SHED. 2. Trash pickup, 3. Home team fills holes at mound and batters box, 4. Visitors drag infield.
Bensenville, Don Giles Field	Trash pickup, field is maintained by park district.
Chicago State	<p>Wear you team’s uniform to get through the entrance gate to avoid paying \$3 for parking.</p> <ol style="list-style-type: none"> 1. Trash pickup, 2. Home team fills in holes on mound and batters box, 3. Visitors drag infield (field equipment is in green container along 3B line. Key in lockbox).
CLC	<ol style="list-style-type: none"> 1. Trash pickup, 2. Do not enter field until facility is opened, 3. Do not climb fence, 4. DO NOT GO INTO RESIDENTS' YARDS FOR FOUL BALLS!!!! 5. BASES ARE IN THIRD BASE DUGOUT ON SHELF NEAR ROOF, AS YOU LOOK OUT ON TO THE FIELD.

**Midwest Suburban Baseball League
Field Requirements**

FIELD	RULES
Grosche	<ol style="list-style-type: none"> 1. Trash pickup, 2. TEAMS FROM LAST GAME LOCKUP the wash rooms, control room, and gates 3. TURN FIELD LIGHTS OFF!!!!!!!!!! 4. LOCK BOX ON OUTSIDE FENCE BEHIND TRANSFORMER.
Judson College	<p>This is a Christian college please watch your language!!!</p> <ol style="list-style-type: none"> 1. Home team takes care of home plate, the mound , and base lines. 2. Visitors drag the infield. 3. Washrooms located in building behind 1st base and spikes are not allowed in this building.
Lake In The Hills	Home team does mound, home plate, and base paths. Visitors drag the infield.
Lake Zurich High School	River Bandits maintain this field; you under their supervision. The River Bandits manager will give you field assignments.
Niles North High School	<p>Read “ALL FIELDS”</p> <p>This is the Sun Devils home field; they will direct you regarding field maintenance requirements. In addition, the requirements as stated in the "All Fields” rules applies.</p>
Oakton Community College	<p>Because this is a college facility, we ask that you respect the field and property rules when using this facility.</p> <p>Field use rules:</p> <ol style="list-style-type: none"> 1. Do not warm up on the grass area between the foul lines and the dugout or on deck area. Use the outfield grass or the foul territory beyond the infield. 2. Do not hit balls against the chain link fences. 3. Police the dugouts after each game and place all trash in the garbage cans. 4. No smoking or tobacco products on the playing field or in the dugout. 5. No alcohol anywhere on the field or campus. 6. If rakes are available, please rake the mound and batters box after the last game. 7. Turn off the lights after the last game and place the padlock on the doors. 8. The last team out should make sure there is no garbage in the parking lot, and should secure the chain at the entrance. The lot must be vacated by midnight. 9. In case of rain, place the large tarp over the home plate area and the smaller tarp on the mound. Use the sand bags to weight the tarps down.

**Midwest Suburban Baseball League
Field Requirements**

FIELD	RULES
Oakton Community College (Continued)	<p>10. You may use the batting tunnel between the softball field and the baseball field. 11. Do not move the batting cage located in the bull pen. 12. Enjoy the use of the field and have a great season.</p> <p>Please check our weather hotline on days following rain for field availability, Thanks, CNMSBL Dir. Of Scheduling Max Reising 773-769-2213 847-604-2444 Weather Hotline</p>
Rec Park	Trash pickup; field is maintained by park district.
Rolling Meadows	<p>We are on probation at this field. Please go back and review rules for all fields.</p> <ol style="list-style-type: none"> 1. You must wait until park district opens field. 2. Do not climb fences. Do not go into yards for foul balls. 3. Garbage must be picked up. 4. Very important, no foul language. Homes and play ground next to field. 5. Parking is available in park district maintenance facility. 6. Park district maintains field.
South Cicero Baseball	<p>Read “ALL FIELDS” This is the Thunder’s home field; they will direct you regarding field maintenance requirements. In addition, the requirements as stated in the "All Fields” rules applies.</p>
Stag High School	<p>Read “ALL FIELDS” This is the Rebel’s home field; they will direct you regarding field maintenance requirements. In addition, the requirements as stated in the "All Fields” rules applies.</p>
St. Charles North	<p>Read “ALL FIELDS” This is the Outlaws’ home field; they will direct you regarding field maintenance requirements. The home plate area and the mound have to be done in addition to dragging the infield. In addition, the requirements as stated in the "All Fields” rules applies.</p>
Trout Park	<p>This field is in a community setting, be on your very best behavior!!!! No foul language will be tolerated!!!! Trash pick up, field maintained by park district.</p>
Wing Park	Trash pickup; this facility is maintained by the park district.

Maps to Fields

Alexian Field

1999 S Springinsguth Rd Schaumburg, IL 60193-5489

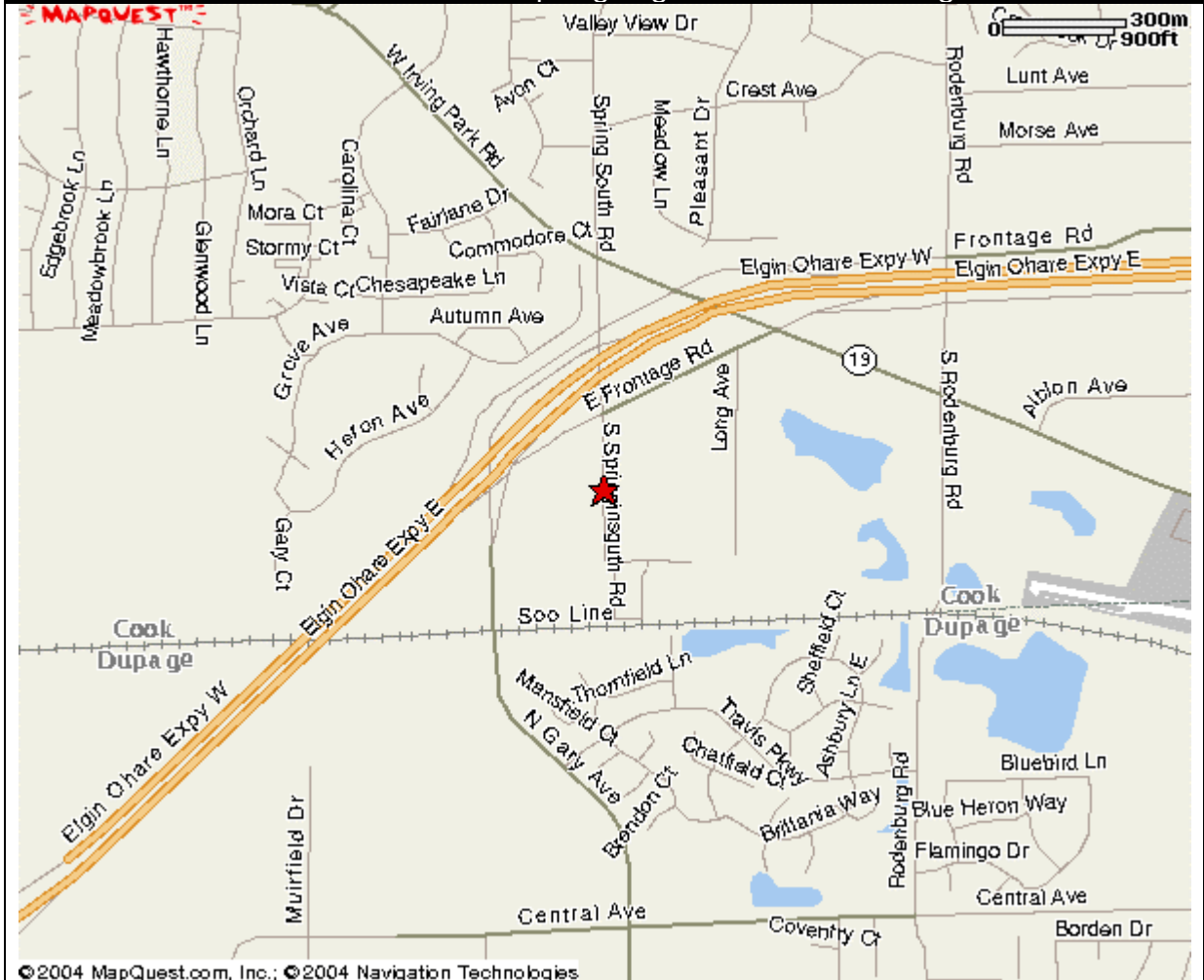

Maps to Fields



Maps to Fields



Maps to Fields

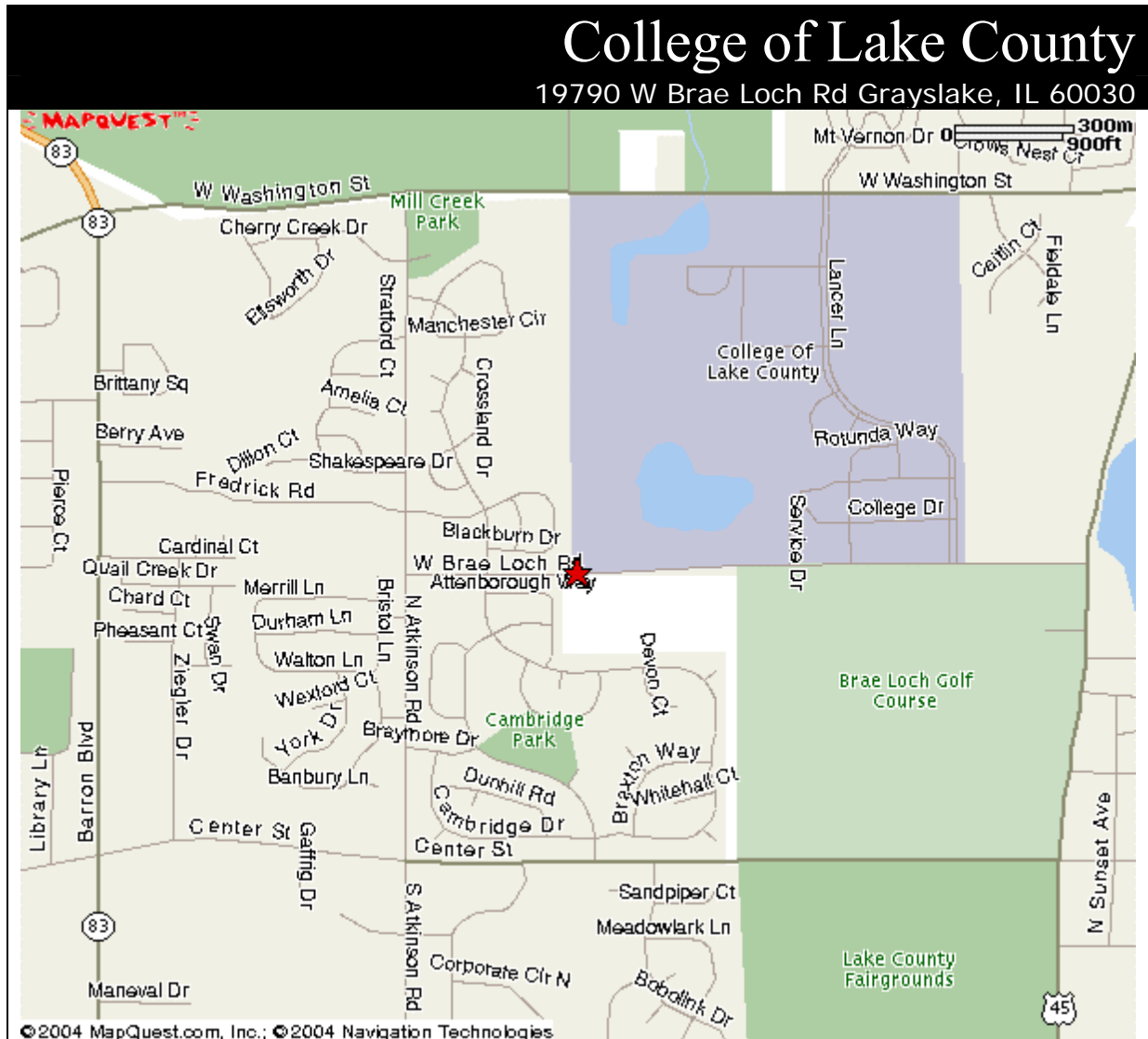

Maps to Fields

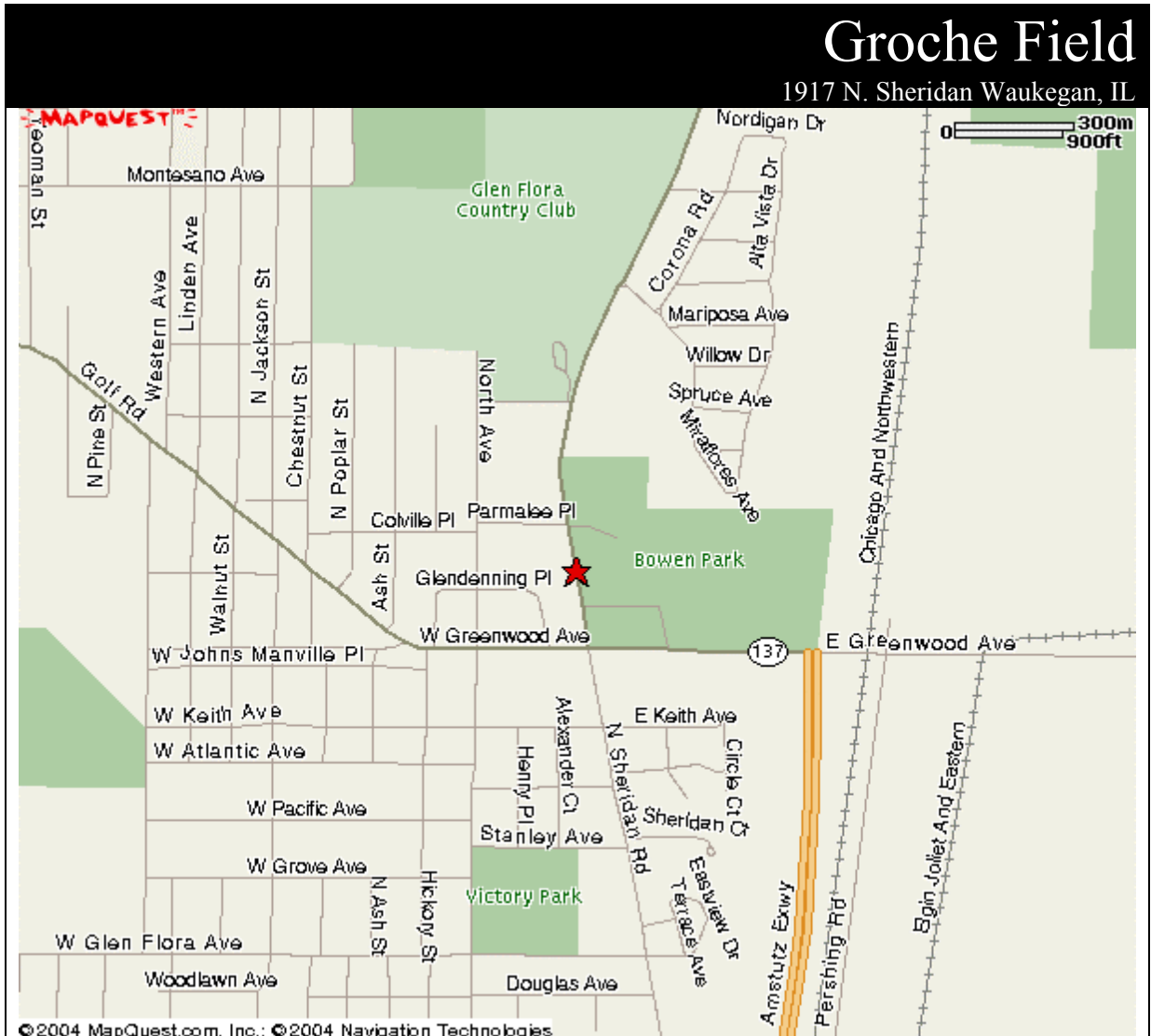

IIT, Illinois Institute of Technology

E 31st St & S Michigan Ave Chicago, IL 60616

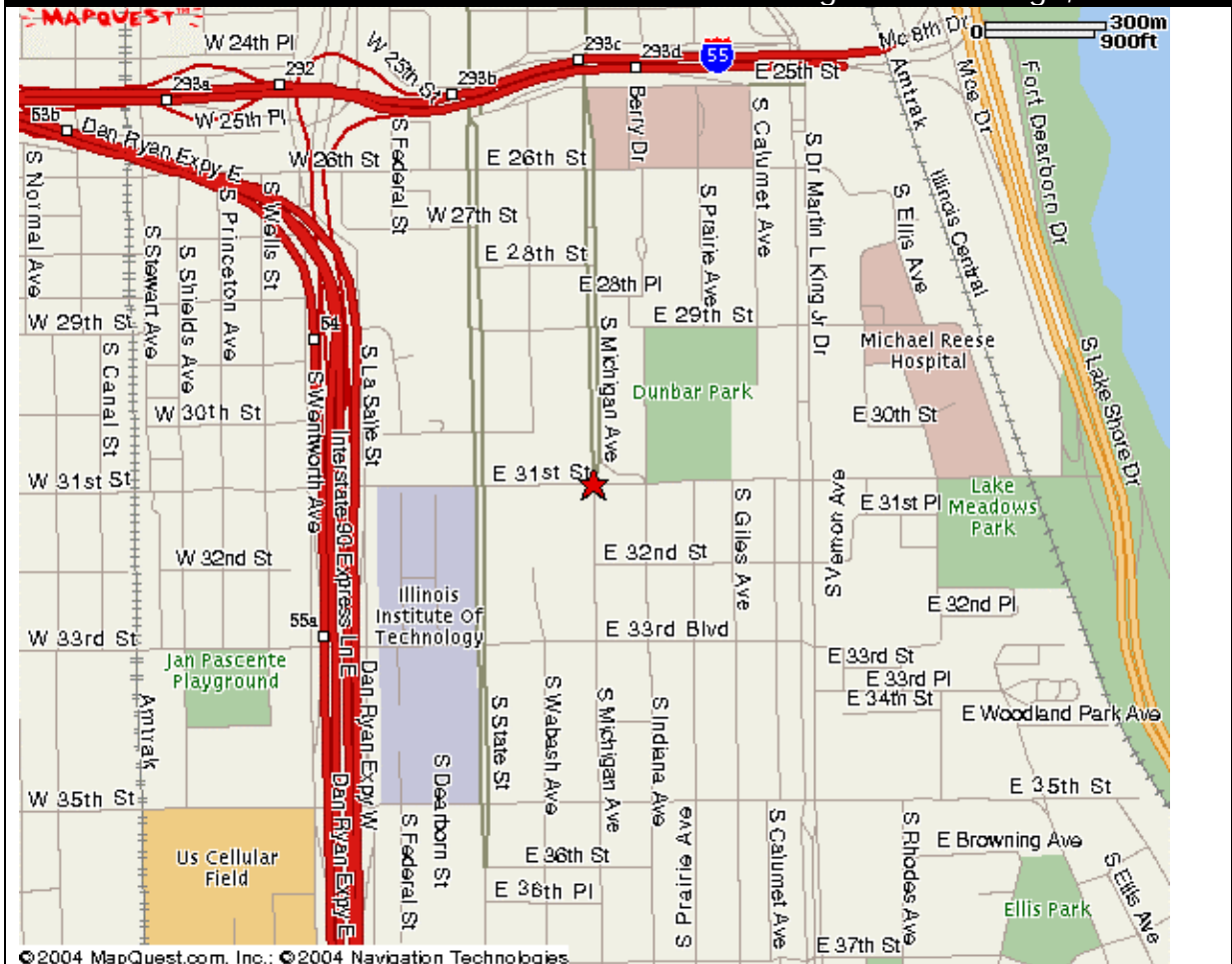

Maps to Fields

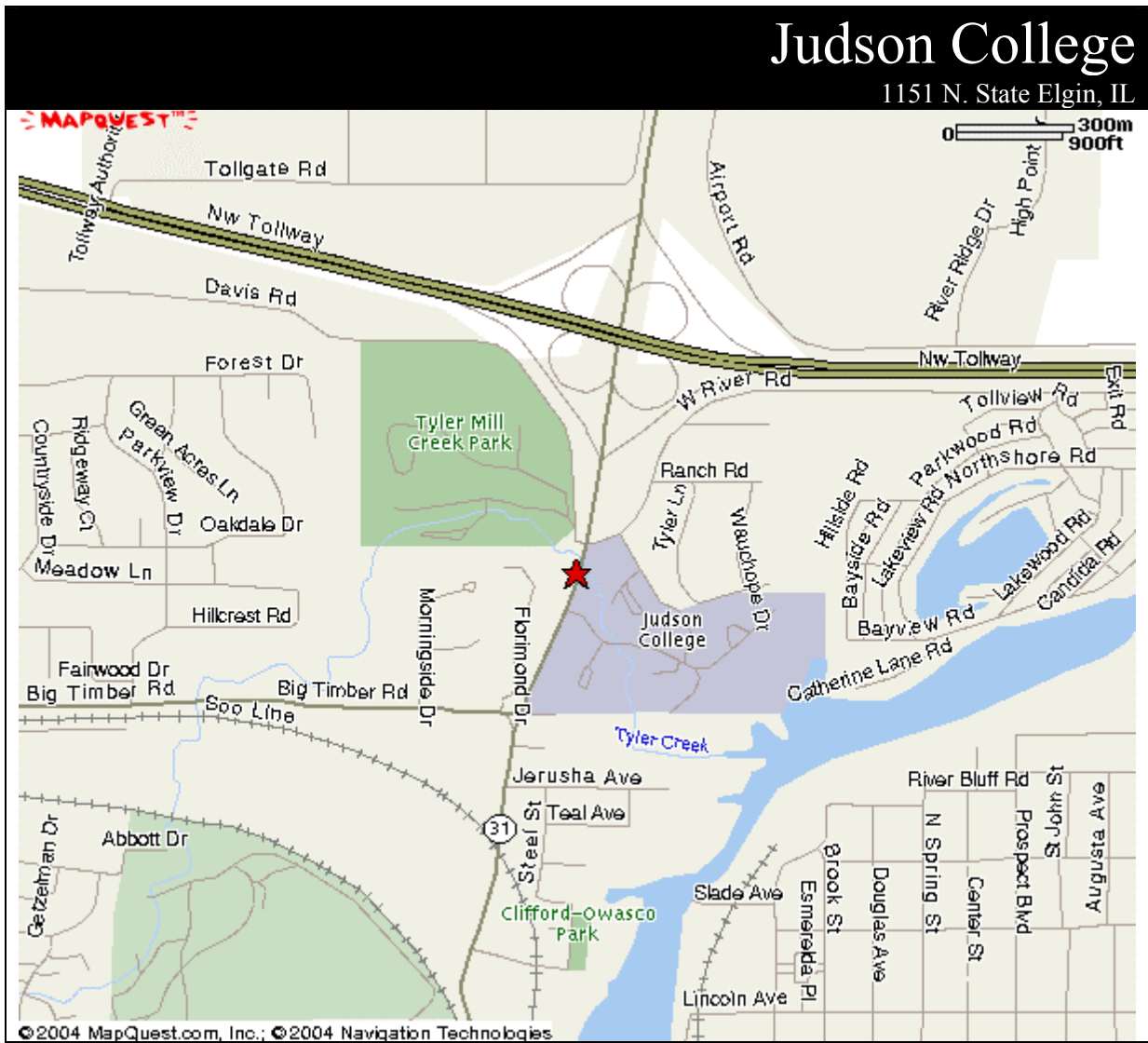

Maps to Fields

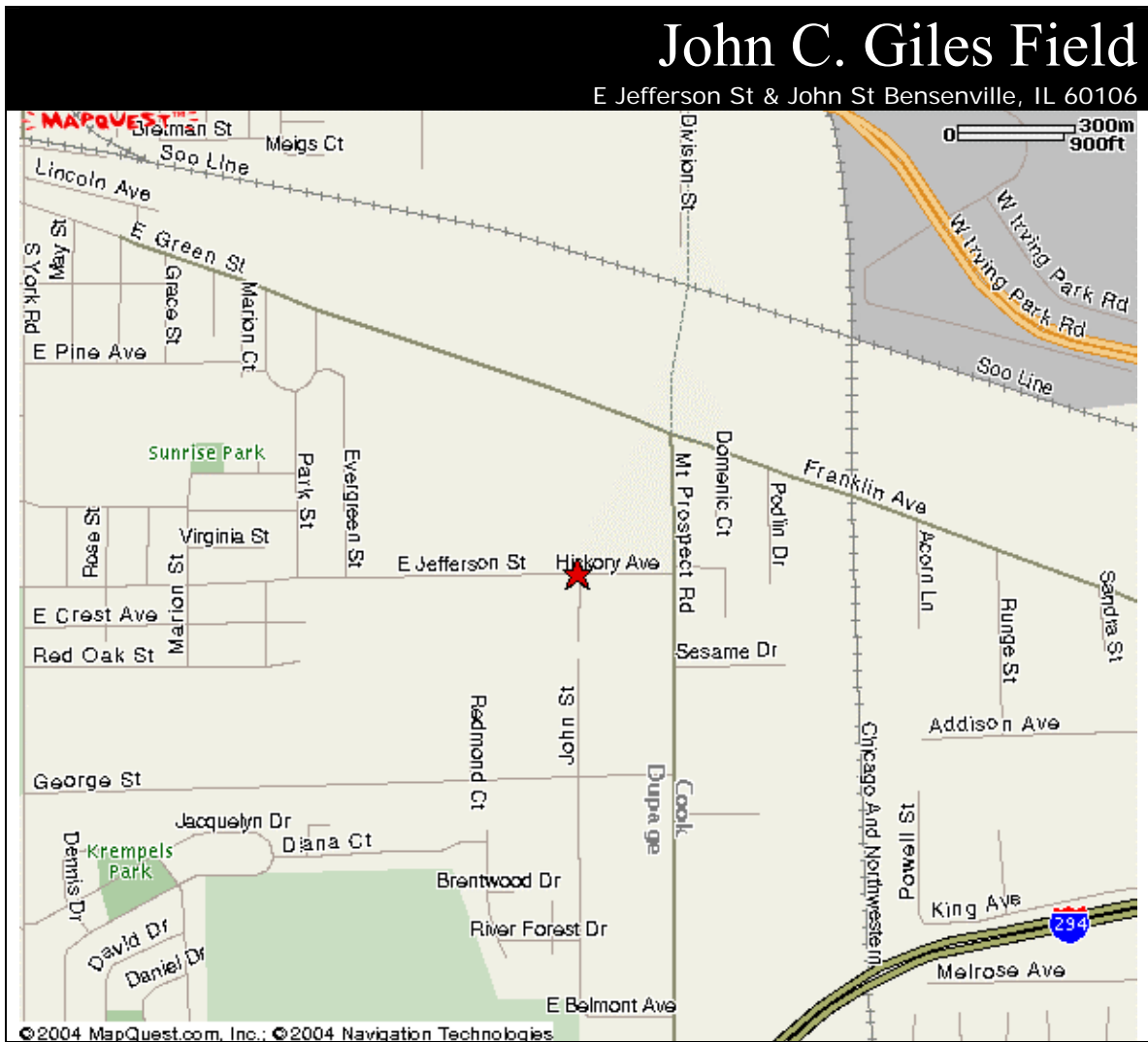

Lake Zurich High School

300 Church St Lake Zurich, IL 60047-1553

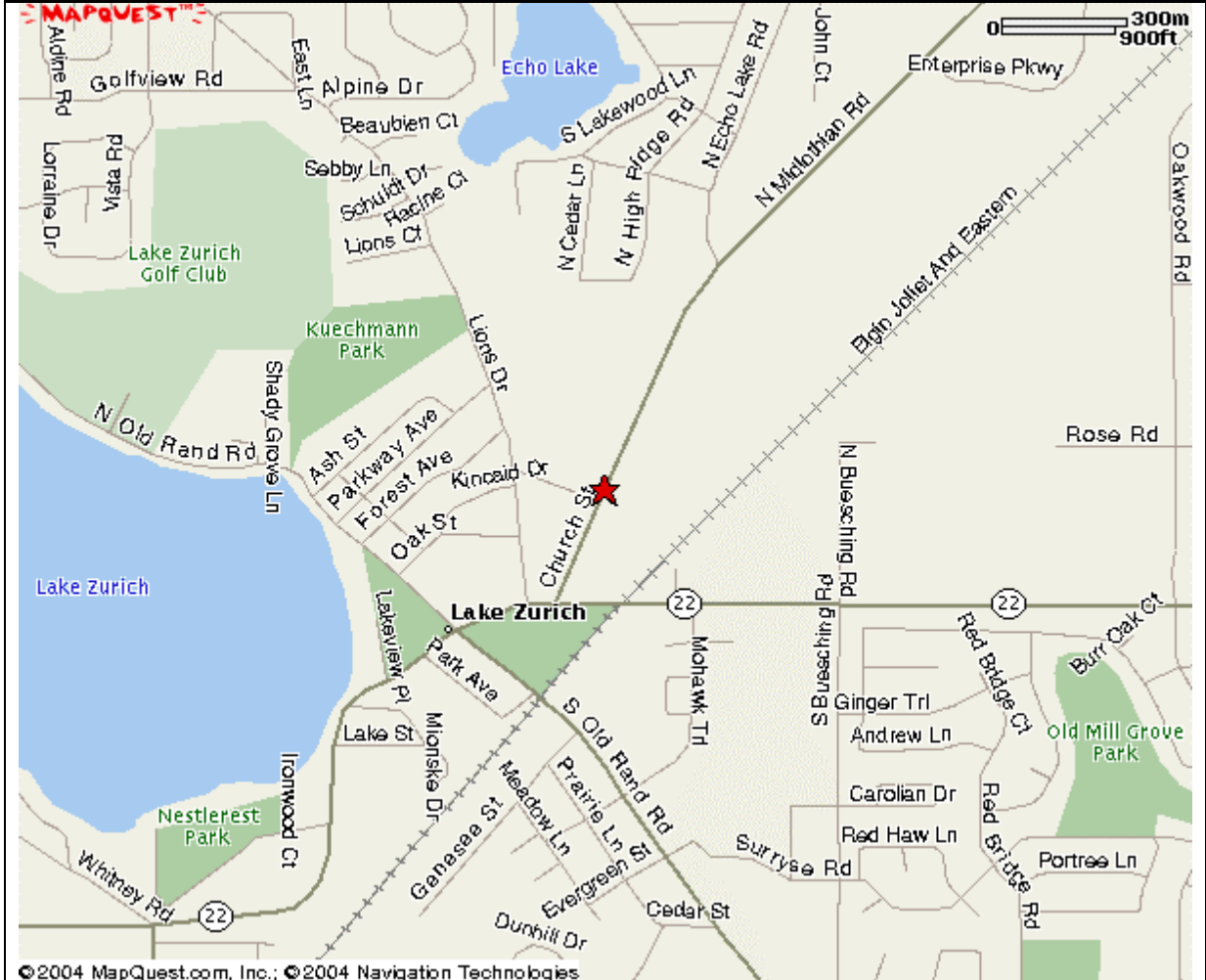

Maps to Fields

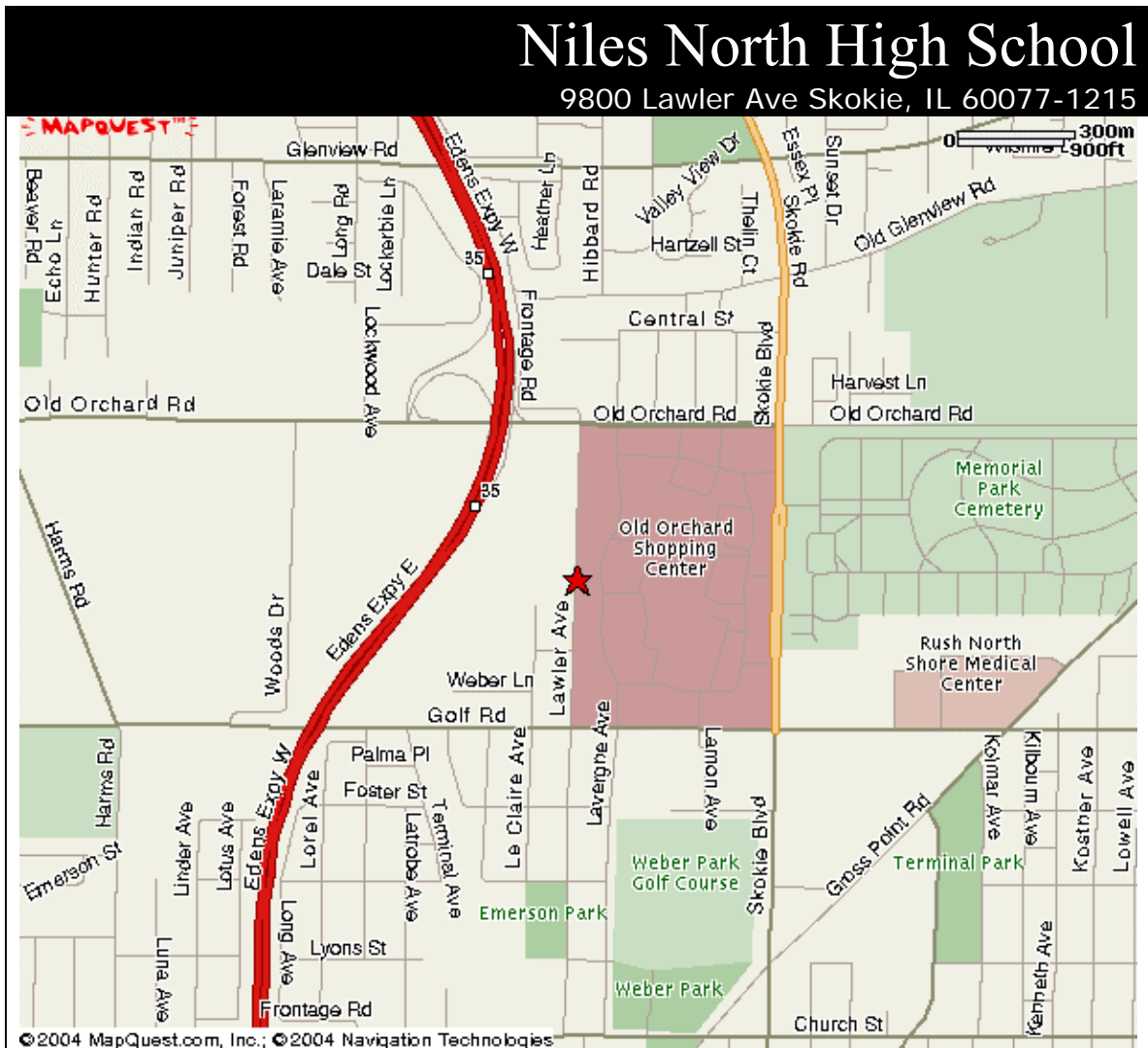

Maps to Fields

Oakton Community College

1600 E. Golf Road Des Plaines, Illinois 60016

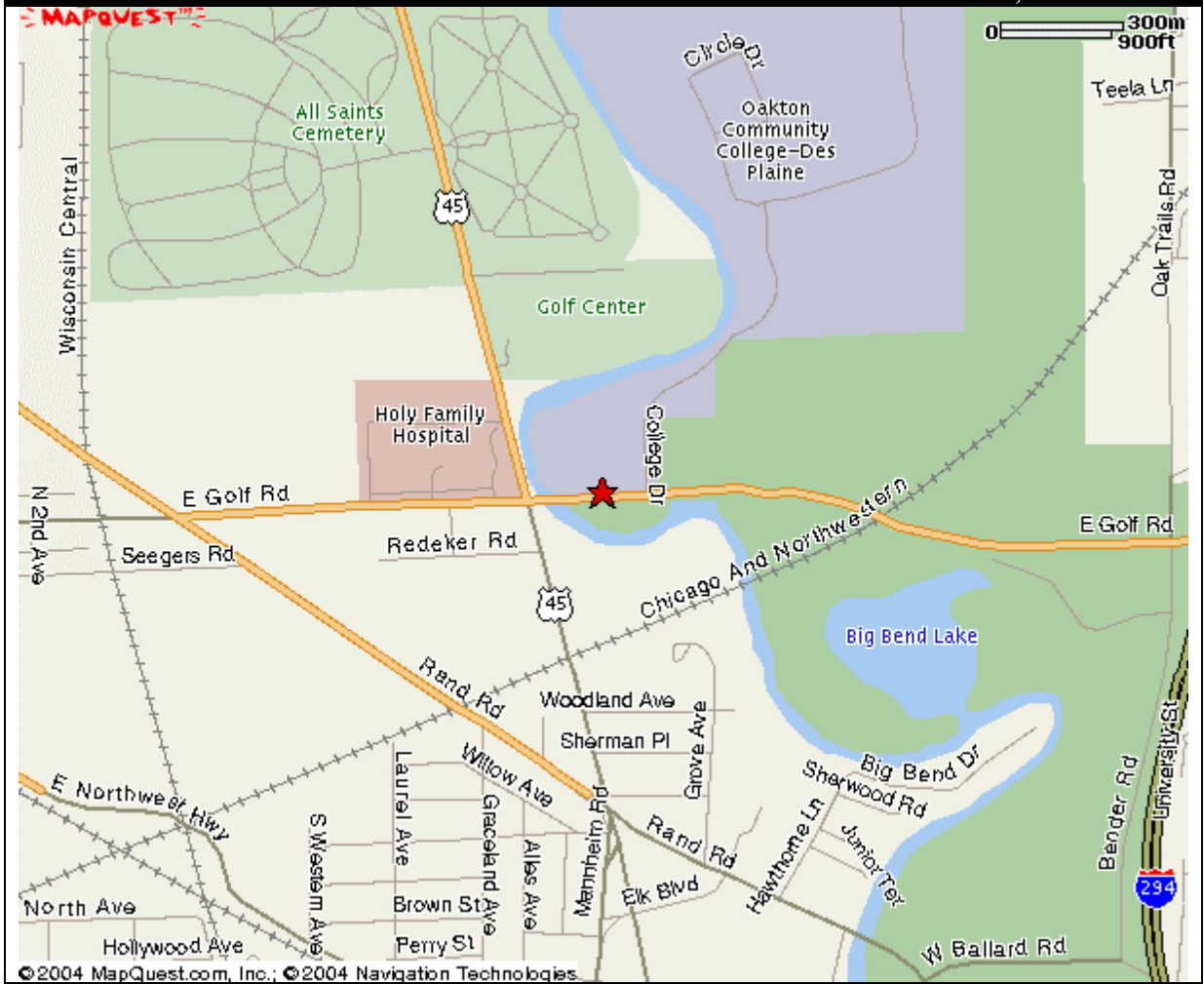

Maps to Fields

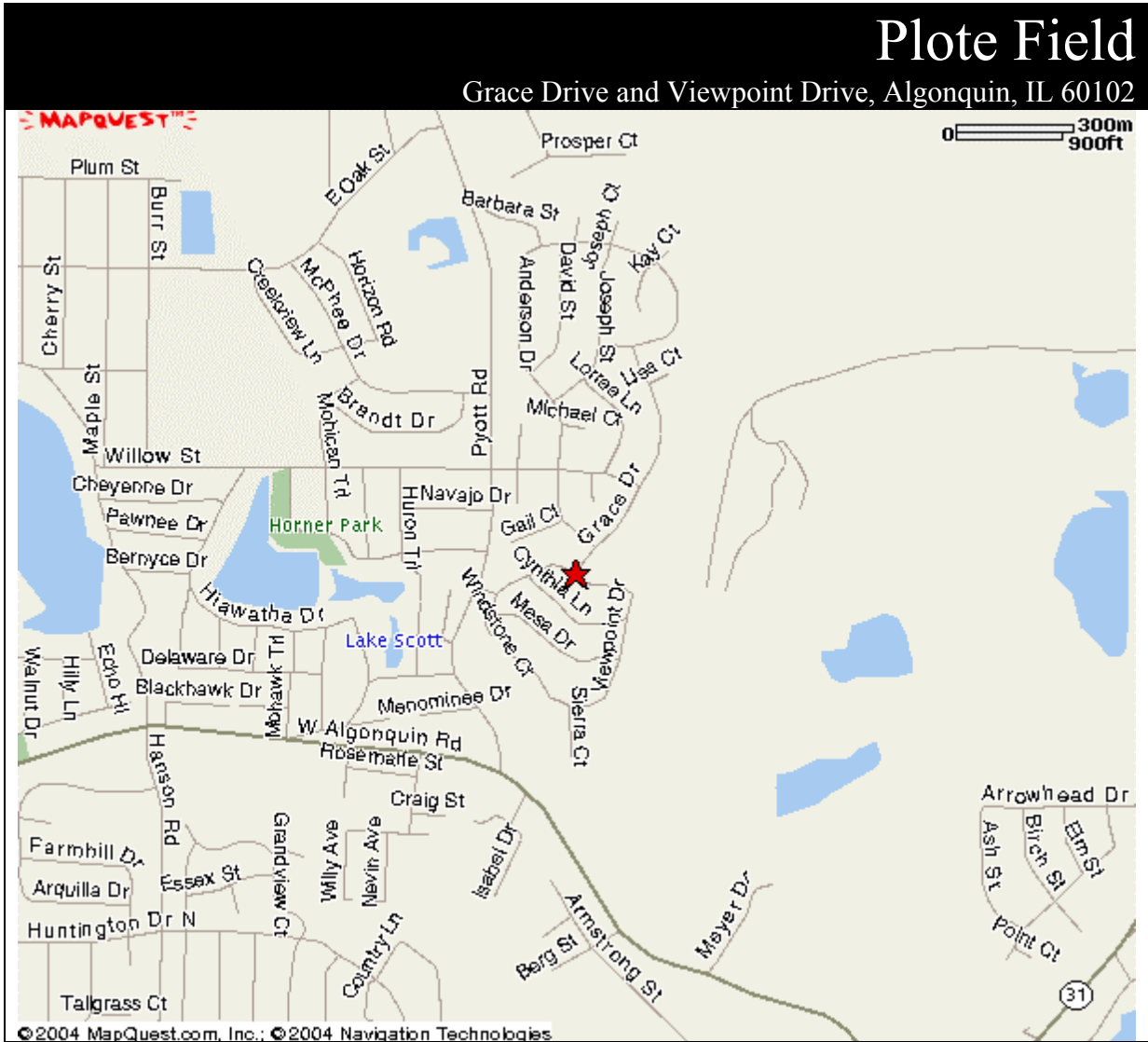

Maps to Fields

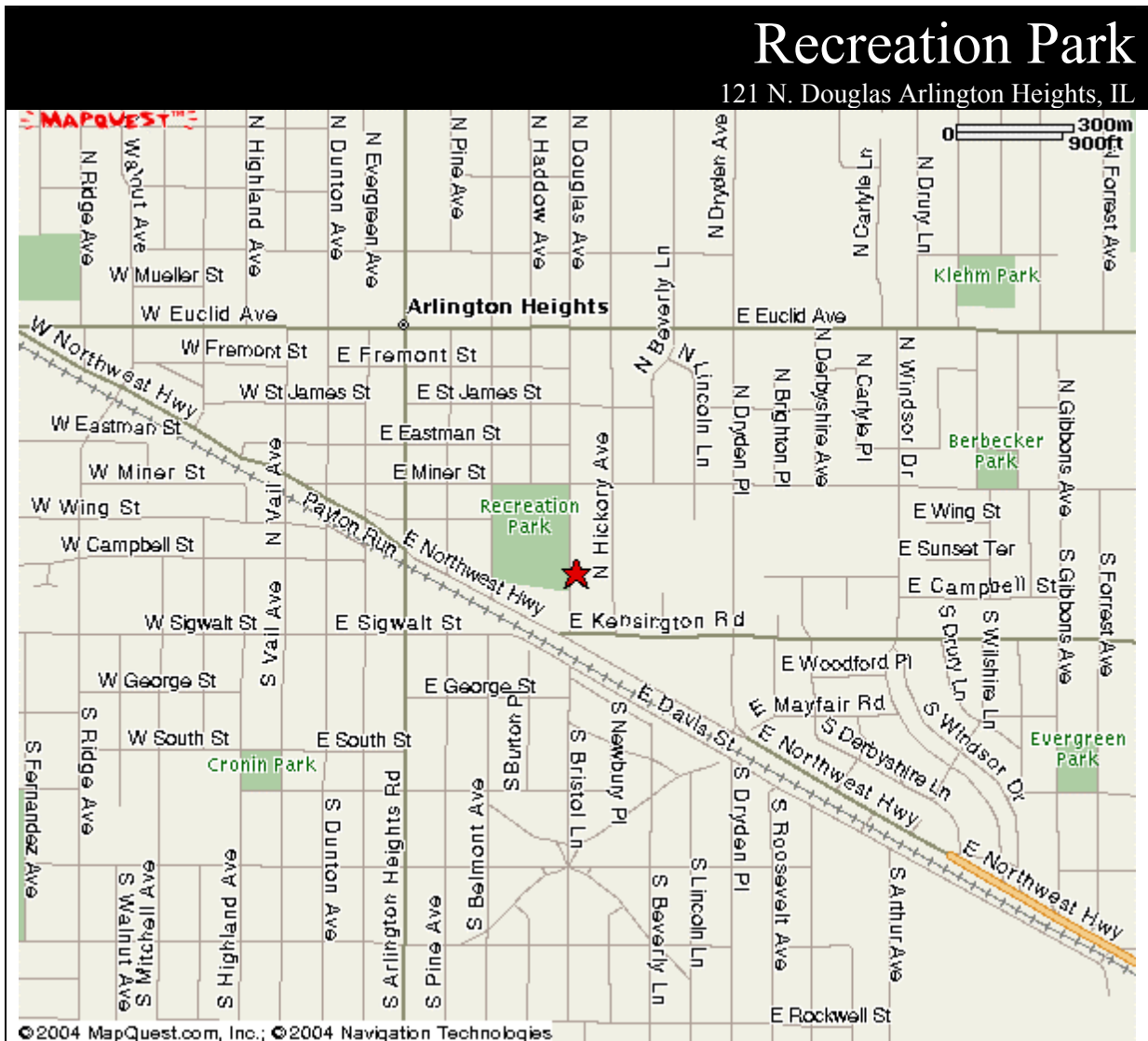

Rolling Meadows High School

3000 Central Rd Rolling Meadows, IL 60008-2559

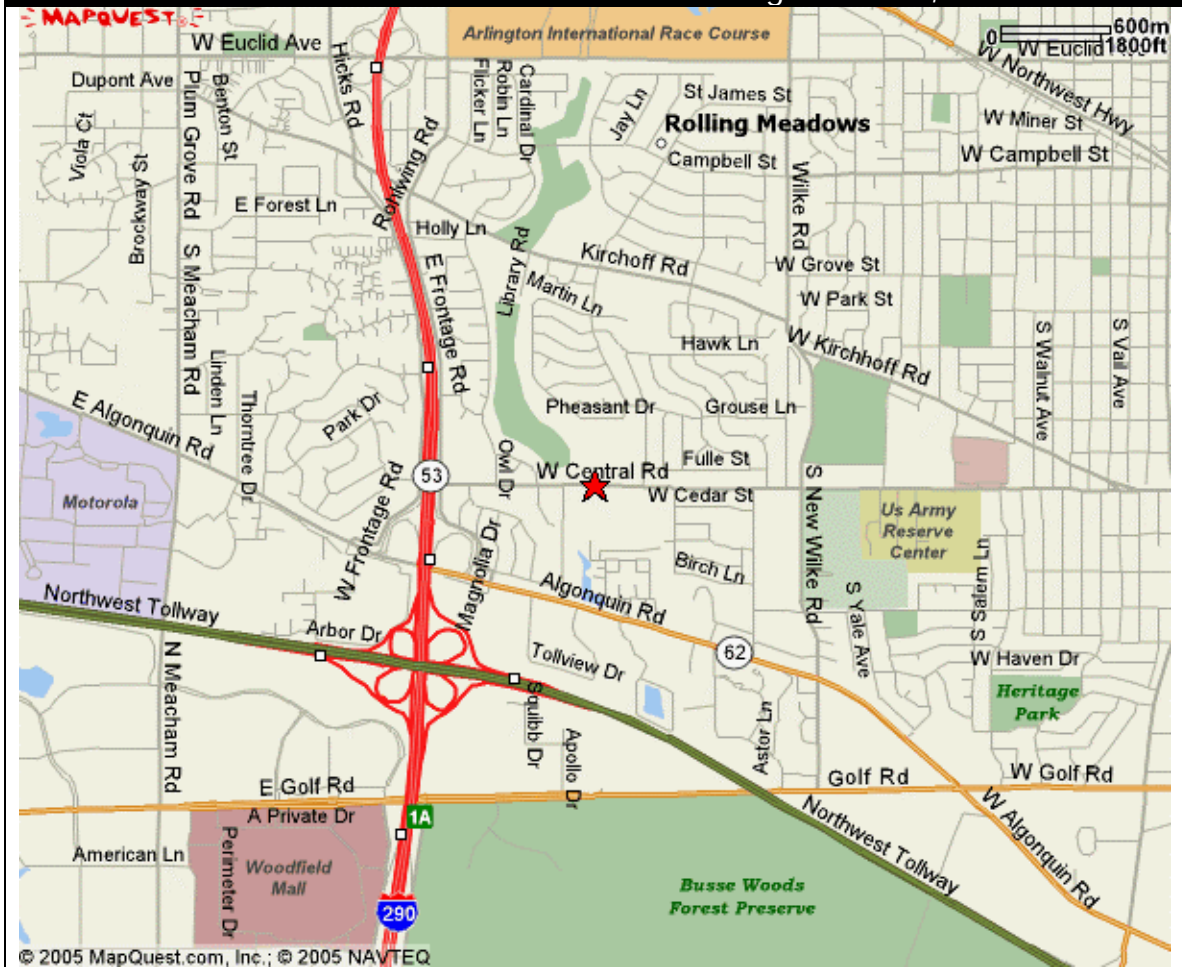

South Cicero Baseball Field

5501 W 32nd St Cicero, IL 60804-3906

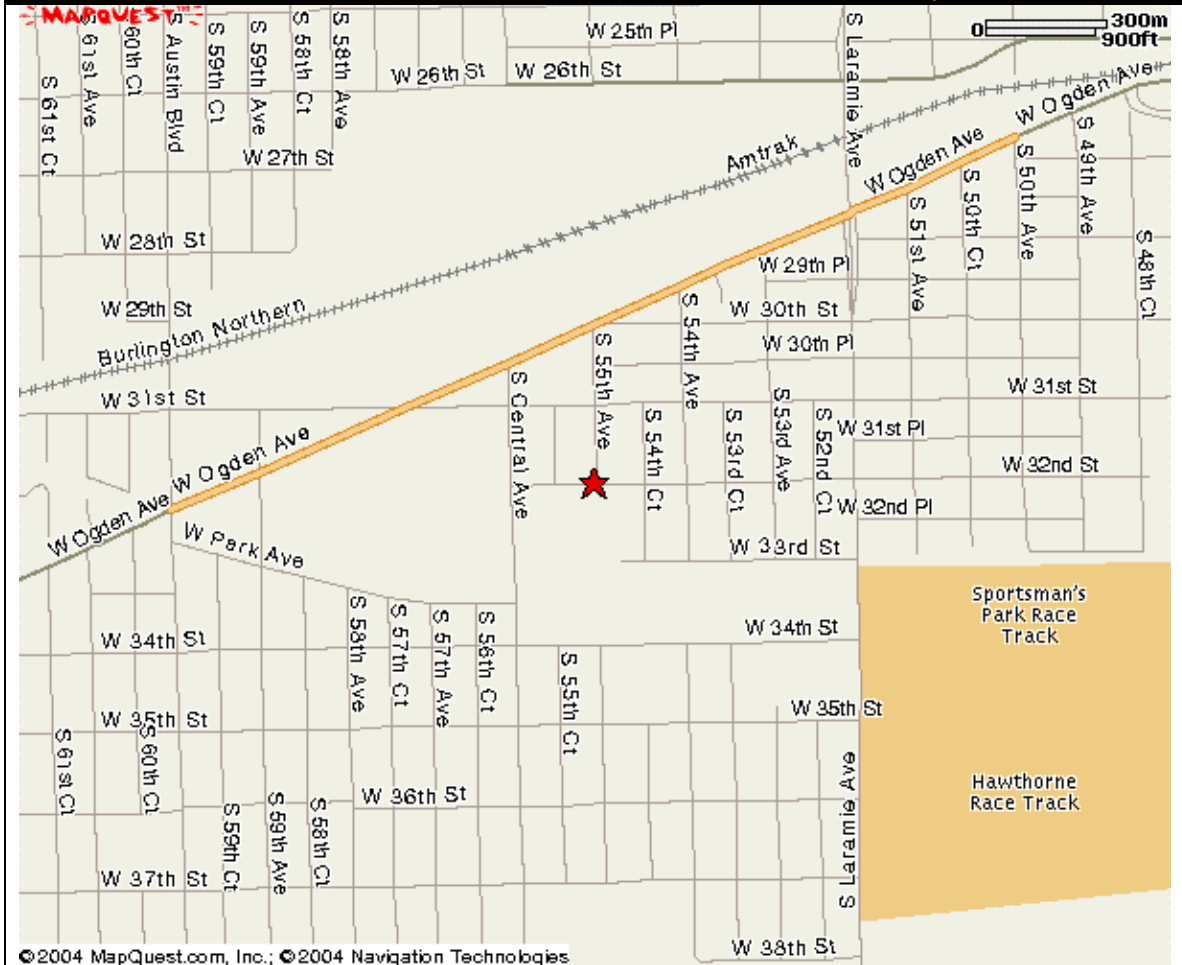

©2004 MapQuest.com, Inc.; ©2004 Navigation Technologies

St. Charles North High School

255 Red Gate Rd, St. Charles IL 60175

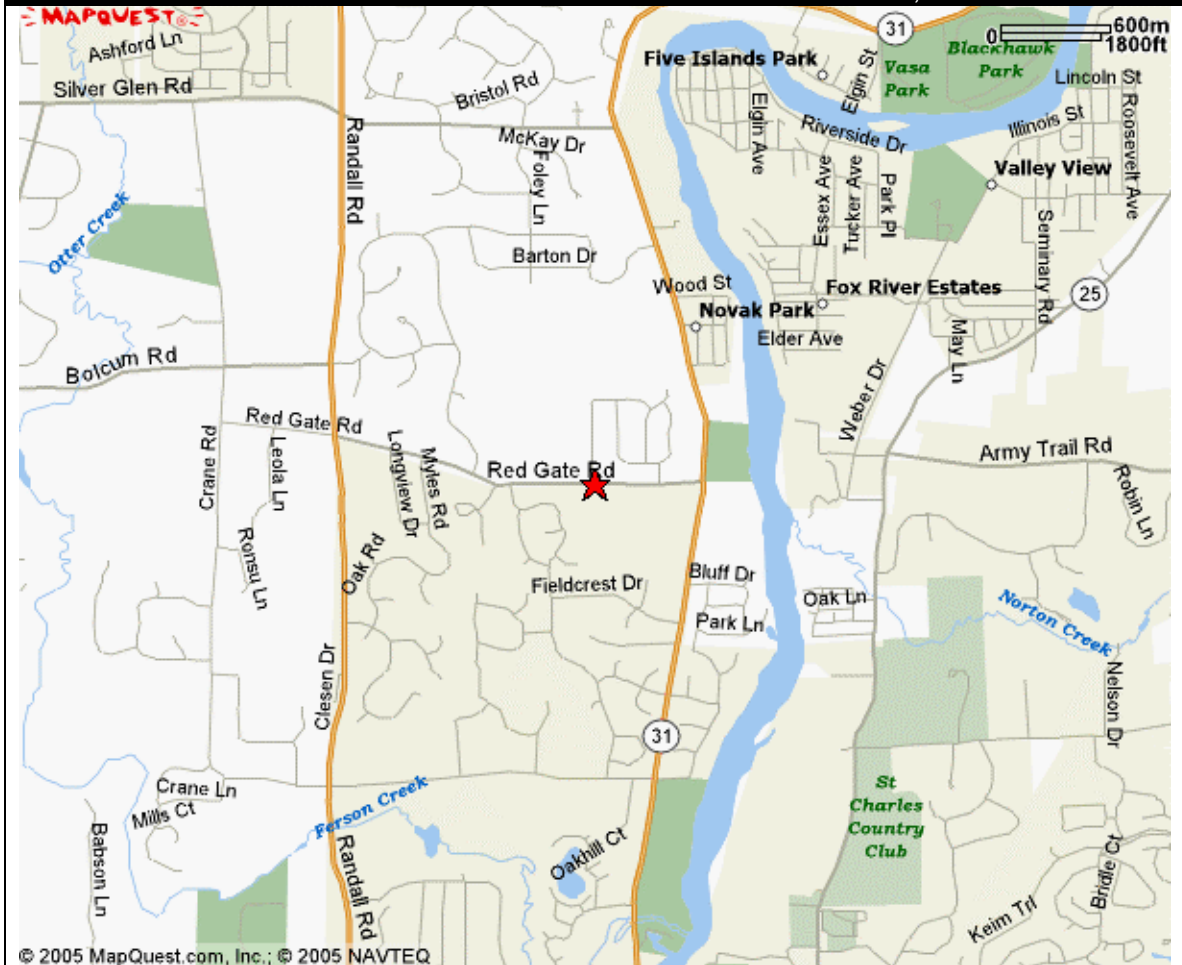

Maps to Fields

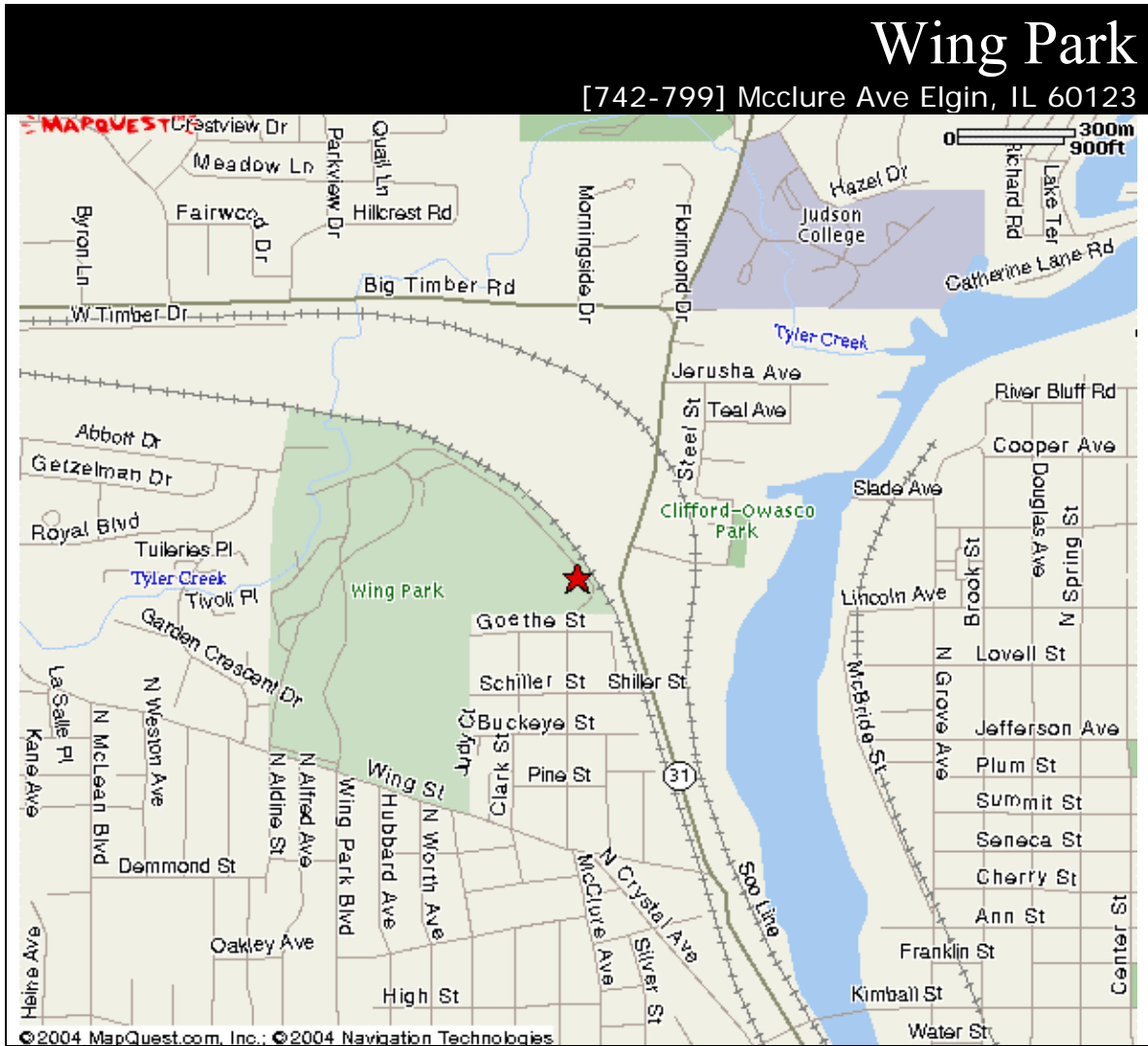

Maps to Fields

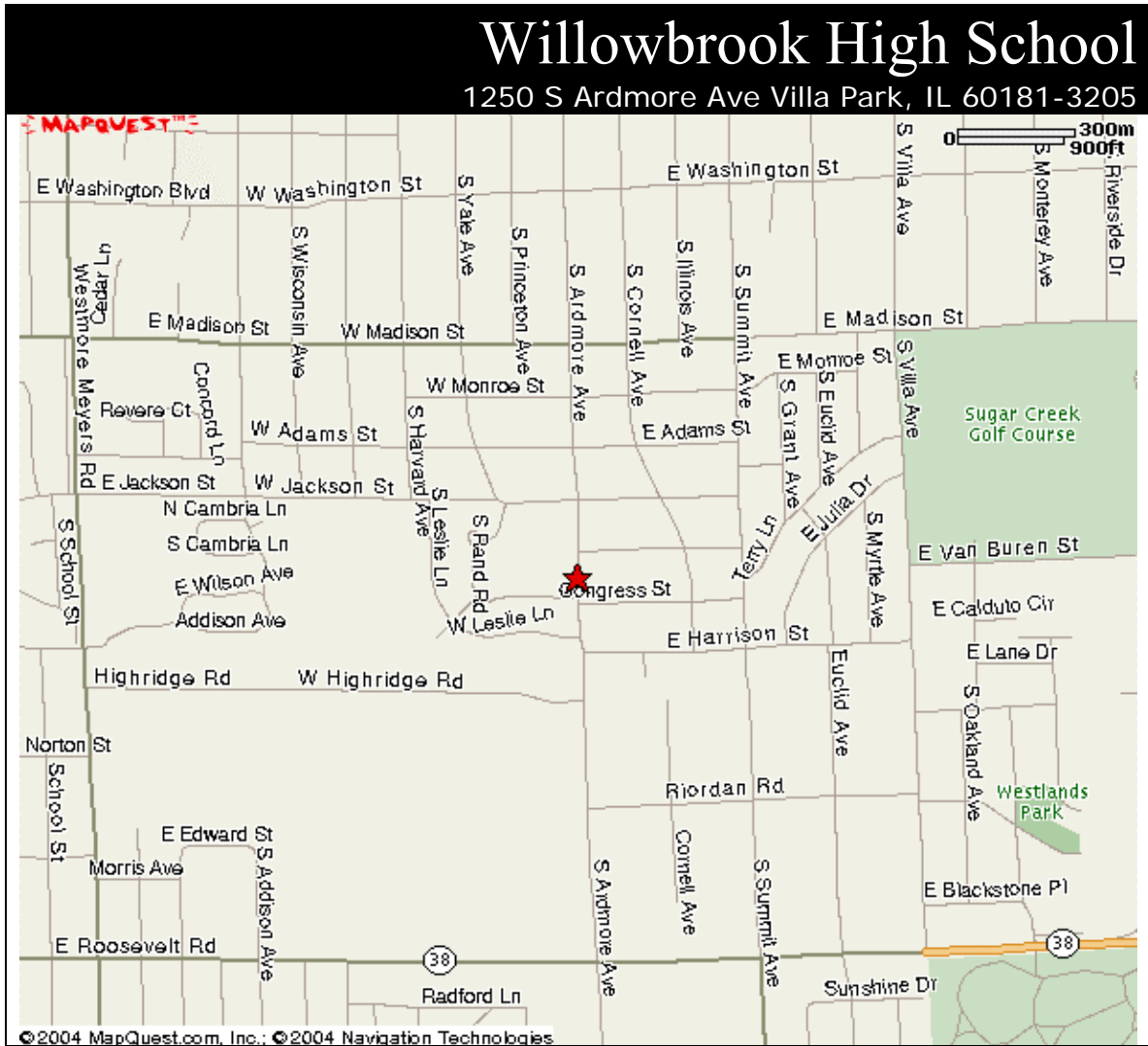

MIDWEST SUBURBAN BASEBALL LEAGUE

FINES

Infraction	Fine
Alcohol-Drugs	Expulsion \$500 Individual or Team
Fighting	\$100 Per Team Ejection-Game
Umpire Contact	\$100 Team Fine Ejection+ Two Game Suspension
Ejection	Next Game Suspension Opposing Team Notifies League
Uniform	\$25 Team Fine Memorial Day
Forfeit	\$150 Team Fine
Field Maintenance	\$50 Team Fine
Field Rules	\$100 Team Fine
Loss Of League Equipment	Cost
Loss Of Field	Team Expulsion
Throwing Equipment	Ejection-Umpires Discretion, No Game Suspension
Key/Lock Loss	\$25 Team Fine
Umpire Threats	\$100 Individual Fine Probation
Property Damage	Cost+ \$100 Team Fine Person Responsible Expelled Team Probation
Missed Score Reporting	\$15 Team Fine
Team On Probation Will Be Expelled On The Next Disciplinary Incident	
Team Expelled Will Forfeit All League Fees	
Manager And Players Banned From The Msbl	
All Fines Due 6:00 Pm Friday Before Next Game	

INELIGIBLE LIST 2005

Adams, Scott	Fronimos, Nick	Low, Ben	Rafter, Mike
Adeo, Rich	Ftikas, Nick	Lyon, Andy	Reid, Scott
Alberghine, Rob	Gierthy, Shawn	Manzi, Daniel	Reitz, Jim
Alberson, Joe	Gonzales, Dave	Marasco, Nick	Rigali, John
Alberson, Frank	Gotto, Rocco	Marvacic, Brian	Riojas, Dan
Amos, Brian	Grady, Edward	Massutto, Jason	Rutkowski, Ken
Arnndt, Ken	Gross, Anthony	Mathison, Chris	Ryan, John
Barnes, Brian	Gutierrez, Jose	Mays, Rob	Salecker, Greg
Baskey, Paul	Guzlk, Joe	McCuiston, Steve	Sampila, Steve
Bender, Brandon	Hallgren, Greg	McGraw, Adam	Sayad, Aaron
Billy Ross, Billy	Hampson, Jim	Medinatt, Ryan	Schackel, Jason
Borrigo, Anthony	Hankins, Randy	Meyer, Michael	Schnur, John
Bravos, John	Henderson, Daryle	Micheloff, Tim	Schweitzer, Tom
Buckingham, Paris	Hendricks, Jim	Middleton, Rob	Scoglio, Mike
Bush, Mark	Heydecker, Corey	Mitchell, Dan	Seeman, Eric
Cannon, Chad	Iller, Wes	Moeller, Dave	Seeman, Rob
Caparaso, Todd	Jaramillo, Jason	Moeller, Michael	Selig, Kevin
Capra, Pete	Jimenez, Oscar	Morgan Jacob	Sippel, John
Carlson, Butch	Johansen, Bill	Morgan, Daniel	Siwek, Jeff
Carlson, Rob	Johansen, Eric	Morgan, Jason	Smith, Derek
Carrasco, Luis	Johansen, Kirk	Moss, Roger	Somenek, Dan
Cervantes, Dave	Johnson, Eric	Muellar, Brian	Somenek, George
Chance, Chris	Kalmuk, Paul	Munin, Nick	Srano, John
Chaseas, Nick	Kamaryt, William	Narter, Ben	Steichen, Mike
Coffman, Chad	Kamin, Phil	Neuhauser, Dave	Stephen, Matt
Collins, Kevin	Karas, Jim	Neuhauser, Todd	Stewart, Larry
Cozart, Shawn	Katta, Bryant	Nickol, Jason	Tatone, Mike
Damago, Field	Keebaugh, Steven	Nowak, Dan	Torres, David
Denoyer, Brandon	Kelly, Derek	O'Brian, Adam	Turek, Tony
DePasquale, Dino	Kirkpatrick, Danny	O'Brian, Billy	Vachy, William

MSBL REPORT ON PROTEST OF GAME

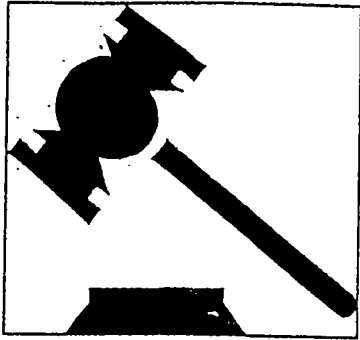

Team Filing Protest: _____

Manager: _____

Opposing Team: _____

Opposing Manager: _____

Date of Game: ____ / ____ / ____

Played at: _____

	Name	Number
Home Plate Umpire:	_____	_____
First Base Umpire:	_____	_____

What are your reasons for filing this protest?

A. Ineligible Player: *In the space below, give name of player and explain why you believe he was ineligible.*

B. Incorrect interpretation of rules by umpire: *Describe the play that occurred, state the call or ruling by the umpire, and state what you believe the proper call or ruling should have been. Please cite the rules of baseball or the league rules that you believe support your point of view. (Use other side for more space.)*

What were the circumstances at the time of the protest?

Team on the field? _____ Number of Outs? _____

Pitcher? _____ Hitter? _____ Count? _____

Bases Occupied by Runners (circle): 1st 2nd 3rd

PROTEST MUST BE POSTMARKED BY MONDAY FOLLOWING THE GAME



MEN'S SENIOR/ADULT BASEBALL LEAGUE

One Huntington Quadrangle, Suite 3N07

Melville, NY 11747



PLAYER'S WAIVER AND CONSENT

Warranty of Players Fitness

The undersigned (hereinafter, "the Player") hereby warrants to the Men's Senior Baseball League, Inc (hereinafter, "the National League") that he is eighteen (18) years of age or over for MABL or thirty (30) years of age or over for MSBL, is in good physical condition and that he has no impairment or ailment preventing him from engaging in the activities of the National League.

Absolute Release of Liability

In consideration of being permitted to participate in the activities of the National League, in any manner, including but not limited to playing, practicing, coaching, spectating or being on the field or in spectator areas for any purpose whatsoever, and fully understanding that participation in the game of baseball includes the risk of serious personal injury, the undersigned Player fully and absolutely assumes full responsibility for the risk of injury due to participation, weather conditions, playing conditions (including the type of bases, plates and fences and equipment) other participants, of any magnitude including fatality, and does hereby forever absolutely release, even for their own negligence and agrees to hold harmless the Men's Senior Baseball League, Inc. All government bodies and landowners that may sanction or permit the participation in the game of baseball and all employees, other participants, agents, servants, officers, public officials, volunteers, game officials and sponsors from all claims for damage whatsoever of any kind now or in the future.

Player's Participation in National Tournaments and Local Leagues

The Player shall participate in the National League as a member on a team called _____, which is a team in the _____, "the Local League." As a member of the National League, Ac Player shall be eligible to participate in the National Tournaments, as organized by the National League, according to the regulations promulgated by the National League. The Player also acknowledges that he must play in at least 50% of all regular season played MSBL/MABL games in a given year, or 15 regular season played games for a single season in the local MSBL/MABL league, which only plays one season annually, whichever is least, to qualify for that year's participation in a National Tournament. Failure to do so will result in the participating team's forfeiture. The Player recognizes as a member of this organization, the authority of the Executive Director, Associate Director, and the Board of Directors to determine and enforce organizational policy. The Player agrees to abide by all Rules and Regulations as set forth by the League Commissioner and Board of Directors. Failure to abide by all Rules and Regulations could result in suspension or expulsion and possible forfeit of all games in which Rules and Regulations were not abided by.

Limitation of Liability

The Player shall participate in the National League's programs and/or use any of me National League's facilities, services or equipment at his own risk The Player waives any and all claims, of whatsoever kind or nature, that may arise against the National League as a result of the Player's participation in the local League's or the National League's recreational baseball program. The Player also acknowledges recognition of the MSBL rules and any deviation of "helmet" requirements (the rule being that all batters and runners must wear helmets at all times) is at their own risk. The Player also acknowledges recognition of the fact that neither medical insurance or liability insurance are inherent with local league/national membership. Medical and liability insurance are made available to all affiliates through the national organization to all leagues, through league director correspondence. A team may elect, on a team basis, to purchase medical insurance for their team independently or as made available through MSBL. Such coverage would include coverage for any injury sustained from participating in an MSBL sanctioned game or practice as provided under the terms and limitations of the insurance Policy. Such insurance would be purchased directly through Gagliardi Brothers Insurance.

I, the Player, have read this release and understand that it is an absolute release and I freely and voluntarily accept its terms and understand it is binding upon me, my heirs, spouse in interest and assigns.

Executed this _____ day of _____, 20_____

Player's Birthdate _____

Player's Signature

Player's Street Address

Player's Name (Print)

City, State, Zip

**MIDWEST SUBURBAN LEAGUE
PLAYER NOTIFICATION
UMPIRES AND FIELDS**

Without exception, to play or participate in the Midwest Suburban League, all players, coaches, and managers must read and sign this document. This is Mandatory! Each player, coach, or manager, including non-playing coaches, managers, scorekeepers, and all other participants, must have a signed document on file with League office.

UMPIRES

- No is allowed on the field during a questionable call by the umpires except the manager, first-base coach, third-base coach, and the player(s) involved in the play. Any player leaving the dugout or their position in the field to get involved in said call will be subject to ejection and next game suspension.
- Threats of any kind to the umpires, whether **VERBAL OR BY GESTURE**, will result in automatic ejection, next game suspension, and a \$100 fine. (Individual fine, not a team fine)
- Physical contact of any kind is a season ending and permanent suspension from the MSL.
- Any team who does not control their players and causes the MSL to lose an umpiring organization, forfeits the rest of their schedule, all team fees, and will be banished from the MSL.

FIELDS

- Any team/player damaging a field in any way (For example: soft toss in to the fence) will be suspended for 3 games and fined the cost of damages plus \$100. This is a team responsibility and the team is held liable for the cost.
- Persons found violating any of the field rules as stated in the Manager's Guide Book will be subject to a \$100 fine. Field rules will be posted in the dugouts of each facility.
- Any team/player causing the MSL to lose a baseball facility will forfeit the rest of their season, all League fees, and will be permanently suspended from the MSL.
- Persons using alcoholic beverages or illegal drugs on our fields will be subject to a \$500 team fine. If caught by anyone from the facility, and the loss of field occurs, the team will forfeit the rest of their season, all League fees, and will be permanently suspended from the MSL.
- In the event of rain, or other conditions causing the field to be wet, no member of the MSL is permitted to try to make the field playable. Only officials from the facility have the right to fix the field.
- Any team that does not clean up fields, dugouts, and spectator areas, or adequately perform field maintenance as required will be fined \$50.

WE ARE HERE TO PLAY BASEBALL!!! NOTHING ELSE!!!! FINES AND RULES WILL BE ENFORCED!!!!

I _____ (print name) of the _____ (team)
understand these rules and will abide by them while playing in the MSL.

Signed

Date

MIDWEST SUBURBAN BASEBALL LEAGUE ALLSTAR GAME

ALEXIAN FIELD

JULY 18 TH

FOOD AND PRIZES

**3 BIKES WILL BE GIVEN AWAY TO THE KIDS
WHITE SOX SKY BOX WINNER**

GAME TIMES

9:30am CENTRAL EAST VS WEST
1:00pm AMERICAN EAST VS WEST
4:00pm BETWEEN GAME CONTESTS
7:00pm NATIONAL EAST VS WEST

CONTESTS OPEN TO ALL LEAGUE MEMBERS

- ★ Home Run Derby
- ★ Fastest Man in the League
- ★ Hardest Thrower

MVP AWARDS AND PRIZES

AWARDS AND PRIZES FOR CONTEST WINNERS

**The \$10 Entry Fee Goes to
Charity**

FOOD CONSESSION

**Home Run—10 Swings
Fastest man - 3-Runs
Hardest Thrower-10 Pitches**

Schedule

9:00AM	Lineups American League Due
9:25AM	Introduction American League All-Stars
9:30AM	Game Time
12:45PM	Lineups Central League Due
12:55PM	Introduction Central League All-Stars
4:00PM	Fastest Man In The League
4:30PM	Hardest Thrower—Radar Gun
5:00PM	Home Run Hitting Contest—Pitching Machine
6:45PM	Lineups National League Due
6:55PM	Introduction National League All-Stars
7:00PM	Game Time

Bring family and friends and help support the Midwest Suburban Baseball League and help Cap Cure.

Even if you think you can't win a contest, have some fun; see how fast you run, how hard you throw, and maybe you'll hit one out!!!!

We will provide pitching machine, stopwatch, and radar gun.



28+
38+ 48+

Baseball Try-outs

April 3rd

There are 3 divisions:

28 and over, 38 and over,
and 48 and over age groups,
with 10-12 teams per division.

www.cnmsbl.com

Call to Register for the Draft
Ross Wolfson - Player Personnel Director
847-390-6670 Ext. 230 (W)
847-942-8294 (Cell)
email: rwolfson@rta-inc.com

Call the League Hotline
for updates 847.604.2444

CHICAGO NORTH MENS SENIOR BASEBALL LEAGUE

Our hardball league is based in the Northern Suburbs of Chicago, playing at 5 different fields in the area (Des Plaines, Northbrook, Bensenville, Arlington Heights & Glenview).

Tryouts this year, Saturday, April 3rd (rainout April 4th), at Meadow Hill Park in Northbrook, IL.

You must reach minimum age at any time in 2004.

Experience should include (but not required) prior hardball playing experience with a High School or College team and/or a burning desire to keep playing. This is a competitive, organized league with an entrance fee of approximately \$275-300 per season, per player.

Your uniform(s) is an additional start up cost to you.

Benefits include: national organization structure and rules with all games in league played on a local basis, regional tournaments in nearby cities and national tournaments in Arizona and Florida.

Each player also receives a National Hardball Magazine, sent quarterly.

Potential players should provide Date of Birth, address, phone number, past experience and positions played.

ADMISSION - 2004 SEASON

SECTION 1 • ROW 1 • SEAT 1

MIDWEST SUBURBAN BASEBALL LEAGUE



Phone: 773.430.7979
Fax: 630.845.0887
Email: larry@
midwestsuburbanleague.com

League Address
MSL
P.O. Box 0191
Batavia, IL 60510

League Hotline
888.339.5585

Website
MidwestSuburbanLeague.com

Web Master
Jason Yormark

MSBL National
One Huntington Quadrangle
3N07
Melville, N.Y. 11747

President
Steve Sigler



Date 12/28/04

Midwest Suburban League
P.O.Box 0191
Batavia, IL 60510

Dear Prospective Sponsor and/or Advertiser,

Thank you for considering sponsoring the Midwest Suburban Baseball League (MSL). The MSL is an organization comprised of over 800 members. We support the Chicago area communities in many ways. Local high schools and colleges receive support for their baseball and sports programs by way of our field rentals and donations. We employ members of the community through our in-house umpiring program. We also support local business by purchasing our equipment and uniforms from a small sports equipment store.

Our membership resides primarily in the Chicago metropolitan and suburban areas. However, our entire constituency also has membership in the Men's Senior Baseball League/ Men's Adult Baseball League (MSBL/MABL) a national baseball organization. We are part of 60,000 members nationwide. We have our own magazine called Hardball and host local tournaments with out-of-town participants. All-Star game's are played at Alexian Brothers Field in Schaumburg.

We provide baseball essentially in its original form on the best available fields within our operating budget. Modifications to customary baseball rules such as the designated hitter rule and courtesy runner rule are designed to allow maximum participation by players and to provide for their safety.

Our games are played exclusively on weekends predominately at north, west, and northwest suburban locations of Chicago, and at Chicago State University in Chicago. Currently, the ages of our membership ranges from 18 to 30 years, but is available to players between the age of 18 and 50 years.

Our website, <http://www.midwestsuburbanleague.com>, will carry advertisers' pages with links to their website. Furthermore, all sponsors will be promoted on this page with links to their website. Our website will be accessed by at least 800 members of our organization and is available to the 60,000 members of the national organization as well as all Internet users. Finally, our membership will be strongly encouraged to patronize all sponsors and advertisers for products and services.

MIDWEST SUBURBAN BASEBALL LEAGUE



Phone: 773.430.7979
Fax: 630.845.0887
Email: larry@midwestsuburbanleague.com

League Address
MSL
P.O. Box 0191
Batavia, IL, 60510

League Hotline
888.339.5585

Website
MidwestSuburbanLeague.com

Web Master
Jason Yormark

MSBL National
One Huntington Quadrangle
3N07
Melville, N.Y. 11747

President
Steve Sigler



The MSL contributes 30 to 40 thousand dollars annually to the athletic programs of local high schools, colleges, and park districts. A list of organizations receiving our contributions last season is attached for your perusal. Four umpiring organizations, and many independents, account for approximately 200 individuals who are also supported by the MSL. These organizations will also have access to our website and literature. They will also be presented with periodic advertisers' and sponsors' pages, and they will be encouraged to patronize the establishments of our sponsors and advertisers.

If you would like to be an MSL sponsor or advertiser, or if you would like to know more about the MSL please contact me.

Respectfully Yours,

Lawrence Kolecz,
President
Midwest Suburban Baseball League

Midwest Suburban Baseball Contributions List

Colleges

Chicago State University, Chicago, IL
College of Lake County, Grayslake, IL
Judson College, Elgin, IL
Trinity College, Deerfield, IL

High Schools

Willowbrook High School, Willowbrook IL
Morton West High School, IL
Barrington High School, Barrington, IL
Warren High School, Gurnee IL

Park Districts

Wing Park, Elgin, IL
Recreation Park, Arlington Heights, IL
Bowen Park, Grosche Field, Waukegan, IL

Support from our sponsors helps the MSL provide for the athletic programs of these organizations.



Men's Senior Baseball League • Men's Adult Baseball League

LOCAL SPONSORSHIPS

Attached please find the Men's Senior Baseball / Men's Adult Baseball sponsorship information. As MSBL/MABL expands into different cities and within existing leagues, local sponsorships are becoming more common for our league. Incentives to offer sponsors and presentation techniques are obviously key ingredients to successful solicitations. *HardBall* magazine, copies of nationally published articles and the enclosed presentation are likely to be excellent tools.

From early experience, the most likely businesses to support our league include:

- Car dealers
- Banks
- Restaurants
- Beverage Distributors
- Radio Stations
- Orthopedics, Chiropractors (we all know too well why!)
- Sporting Goods Stores

Try and be realistic with your dollar request and only offer the prospective sponsor benefits you can realistically provide, as you want this sponsor to support you for several seasons.

Benefits/Exposure

You could offer to the prospective sponsor:

- Title your team name.
- Mention that your team standings are published in your local newspaper and *HardBall* Magazine.
- Access to your league mailing list.
- Publicizing the sponsor at league meetings.
- On site visibility with a sponsors banner.
- Offer the availability to distribute sponsors promotional materials, including flyers, coupons, etc.





Men's Senior Baseball League • Men's Adult Baseball League

HOW TO LOOK FOR SPONSORS

As MSBL/MABL expands into different cities and within existing leagues, local sponsorships are becoming more common for our league. Incentives to offer sponsors and presentation techniques are obviously key ingredients to successful solicitations, with *HardBall* magazine and the MSBL/MABL promotional tape being excellent tools.

From early experience, the most likely businesses to support our league include:

- Car dealers
- Banks
- Restaurants
- Beverage Distributors
- Radio Stations
- Orthopedics, Chiropractors (we all know too well why!)
- Sporting Goods Stores

Many MSBL/MABL leagues have received and utilized our media packages with success. Feel free to request our assistance in preparing sponsorship-type letters, which include demographic information as well.

I have always maintained that sponsorships should be an individual team project and one that the "league" does not pursue. With so many important aspects of league management facing our League Presidents, "team" sponsorships should be treated exactly this way.

SOME HELPFUL GUIDELINES:

- Find a sales person to do the calling. Sales people are comfortable with the rejection you will face in this process.
- Be professional when you make a call. Whenever you meet with a potential sponsor, be sure you are in a jacket and tie.
- Always follow up and if you tell a sponsor you are going to do something for him, be sure to do it. Undersell and over produce.
- Sponsors like to know the players are "invested" in the process. If your team needs \$3,000 for the year, ask the sponsor for \$1,500 and be sure he knows that the players are putting up the rest.
- Remember, you are selling advertising, not asking for a donation. Highlight the benefits of this type of advertising. Understand the objections and overcome them with benefits (sales people understand this).



- Tell a sponsor about the benefits, deliver the benefits, and then remind him over the year that you delivered the benefits. Say "thank you" whenever you see him and be sure to nurture the relationship over the year. It is much easier to "renew" a sponsor every year than to find a new one.

COLD CALLS

As mentioned, this is the toughest part. Be ready! Get yourself copies of Hardball magazine, the brochure, the national tournament programs, any articles that you might have on your league, the MSBL promotional video, a list of all the benefits of sponsoring your team, all the things you can do for him if he sponsors your team.

- Weekly scores in the paper (Joe's Bar 6 – Willie's Deli 1).
- His name in the paper every time there is an article about the league.
- Names and addresses of the players if he plans to "sell" to them (many sponsors view this as a great way to get leads for whatever they sell).
- Name in Hardball magazine and national tournament program when your team is mentioned.
- Free advertising in your league newsletter, if you have one.
- Etc., etc., etc.

Remember that you are selling a product, not asking for a donation. You have to believe that what you are selling is worth the price. You cannot fake enthusiasm. That is why sales people are the best at this job.

COMPANIES

Any organization is a prospect. The ones who work best are the ones who want to do business with adult men and families. We have had investment firms, car dealers, bars, restaurants, grocers, leasing companies, orthopedic offices, computer companies, beer distributors, community hospitals, life insurance companies, pizza parlors and many more. Look for companies who are starting out new in your market area. The amount is not critical. How big an amount is not a factor. If you are straightforward and honest with your sponsor and deliver exactly what you promise, you should have no trouble maintaining the relationship. Very few people get treated like that in business and they appreciate it when you are honest with them.

Look for companies that do a lot of sponsoring in the community. Contrary to popular belief, the ones who do a lot of sponsoring are used to spending the money. Also watch for companies who simply do a lot of advertising. When you see Buddy's Carpet Barn launch a gigantic new sales promo campaign, Buddy is interested in building sales revenue and if you are there to help him, you are a welcome guest. "Buddy, have I got a way for you to reach an audience that your new commercials may not be reaching." Chances are, Buddy will talk to you. That is very different from "Are you interested in making a donation to MSBL?"



MEDIA

Anything you can get printed or said about your league will help legitimize your effort.

SUMMARY

Sponsorships are not easy to secure, but as discussed in our "Securing a Field" section, differentiating yourself will help legitimize your proposal. Keep your requested amounts reasonable and following through/keeping them informed will help you maintain any sponsor you secure.





Men's Senior Baseball League • Men's Adult Baseball League

SAMPLE LETTER TO POTENTIAL SPONSORS

(Use team/league letterhead stationary, if available)

(Insert Date)

Dear Prospective Sponsor:

Thank you for taking the time to discuss the possibility of your firm becoming a sponsor of the (Insert Team or League name).

Snow skiers have an alternative to summer – artificial slopes. Dieters have an alternative to sugar – Nutrasweet. Now, baseball players 18 & over, 30 & over and 40 & over have an alternative to softball – the Men's Senior/Men's Adult Baseball League.

No more swinging at heads of lettuce. No more standing on base until the ball is hit. No more hitting to four outfielders. MSBL/MABL is the real thing!

The Men's Senior Baseball League, a hardball league for men 18 years old and over, and 30 years old and over, was established to provide an alternative to softball. Our organization has expanded to over 300 major cities and 40,000 players in only our thirteenth full operating year. We realistically expect our membership to grow to over 50,000 within the next few years. The participants of MSBL are all united by a common passion – baseball. They are not your typical out-of-shape weekend softball players. MSBL members are serious athletes. Our league features many notables, including prominent former major league baseball players and political figures. We have received numerous letters of endorsement, have established an alliance with PONY Baseball (500,000 members), and are now members of USA Baseball as well.

MSBL has established credibility at an equally rapid pace. In just twelve years, MSBL has been featured in over 800 city newspapers, USA Today, Sports Illustrated, Sporting News, and numerous local radio and TV features. Our league has been featured on the Today Show and Good Morning America. This national coverage has provided a public awareness, which has helped accelerate the growth of our league.

So what does this all mean to a potential sponsor? It means that MSBL, although still relatively young, is a rapidly growing organization on a local and national basis.

MSBL/MABL has held thirteen World Series national tournaments in the Phoenix area starting in 1988. From 38 teams in 1988, the tournament entertained 340 teams in 2000, which was title sponsored by StreetZebra.com. Just For Men title sponsored the tournament in 1998 and 1999. Teams from Canada, Australia, Croatia and the Virgin Islands also participated. The MSBL World Series is recognized as the largest amateur baseball tournament in the world, and was televised on Sports Channel America three times.



*One Huntington Quadrangle, Suite 3N07, Melville, NY 11747
Tel. (516) 753-MSBL • Fax (516) 753-4031
WWW.MSBL.com • e-mail us at MSBLNational@MSBL.com*

Men 18 and Over

**YOU DON'T HAVE
TO SETTLE FOR
SOFTBALL.**

**Play REAL HARDBALL
in the**



MEN'S ADULT BASEBALL LEAGUE . . .

**A National Organization
operated for adults over 18**

Teams being formed NOW for 2004

- ! National Organization Benefits**
- ! All league games played locally**
- ! All players receive *HardBall Magazine***
- ! Regional tournaments in nearby cities**
- ! National tournaments in Arizona and Florida**

**Don't get shut out of another season!
New teams are being formed NOW**

<p>For more information call:</p>
--

4th of July

Mid-Summer Classic



When: 4th of July Weekend 2005

Dates: Saturday, July 2nd
Sunday, July 3rd
Monday, July 4th

Where: Chicagoland Area

Entry Fee: \$50 per player

Prize Money: 1st - \$1500
2nd - \$500

*10 team minimum

OFFERING 2 DIVISIONS:

AA (NATIONAL) & A (AMERICAN)

ENTRY DEADLINE:

JUNE 1ST, 2005



P.O. Box 0191 Batavia, IL 60510

Phone 1: 773-430-7979 Phone 2: 847-293-0667

Email : info@midwestsuburbanleague.com

Web : <http://www.midwestsuburbanleague.com>



Tournament Host:

Midwest Suburban League

Chicagoland's Largest Mens Baseball League

The Midwest Suburban League is a mens adult baseball league that plays across the Chicagoland suburbs.

The MSL hosts a 4th of July tournament including 2 playing levels National (AA) & American (A).

All teams are guaranteed 3 pool play games to be played on Saturday & Sunday. Depending on the number of teams participating, either the top 2 or 3 teams will advance out of each poll for a single elimination playoff tournament.

For more information or to enter your team contact us today!

**CUBS BASEBALL & TASTE OF CHICAGO
IN TOWN THIS WEEKEND!!**

2005 MSBL/MABL National Tournament Calendar

	Tournament	Dates	Age Groups
	Disney Holiday Classic Orlando, Florida	January 14 – 17	18+, 28+, 38+
	Desert Classic Palm Springs, CA	January 14 – 17 (Fri., Jan. 14 – MSBL/MABL Golf Tournament)	18+, 28+, 38+, 48+
	Kickoff Classic Las Vegas, Nevada	Week 1 – March 12 – 14 Week 2 – March 19 – 21	Week 1 – 18+/38+/ 55+ (Wood Bat) Week 2 – 28+/48+
	Las Vegas Open	Memorial Day Weekend May 28 – 30	18+/28+/38+/48+/55+ (38+, 48+, 55+ wood bat) 18+/28+ Metal and wood bat divisions

Contact Information:
National Office
Ph: 631-753-6725
Email: Info@msblnational.com



President's Report

News and Announcements from MSBL National



MSBL Hall of Fame to Induct Panasuk

Tony Panasuk, founder of the Denver MSBL, will be inducted into the MSBL/MABL Hall of Fame at the 2003 World Series. The Induction Ceremony will take place at the World Series Banquet on November 1st at the Rustler's Roost Steak House in Tempe, Arizona.

"I just happened to read a small item in *USA Today*," Panasuk recalled. "It was very small piece, but it caught my eye and, as soon as I realized what it was about, I became very curious. This man, Steve Sigler, in Long Island, New York had started up a recreational baseball— not softball, baseball—league for men over the age of thirty, and it really taken off. Now, he was looking for people who wanted to join his new national association and participate in his first World Series, planned for November, 1988 in Phoenix."

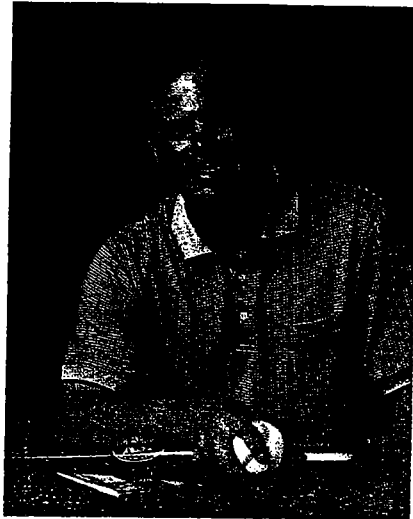

Tony Panasuk

"It sounded like a great idea," Panasuk said. "So I called the phone number in *USA Today*. Steve and I hit it off right away. I was really impressed with his energy and his commitment to this idea. I realized that he would succeed and I decided to become part of what he was building. Technically, the Denver MSBL was established over the Winter of 1987-88, but our first season was 1988."

Working together, Steve and Tony approached the *Rocky Mountain News*, a large metropolitan daily paper. Around Easter of 1988, the paper ran a full page article on the new league. "That was a fantastic article," Tony said. "I got 250 phone calls in one week. In very short order, we had eight teams. We were in business."

Today, the Denver MSBL/MABL has 50 teams, comprising 15 in its MABL division, 35 in its MSBL age brackets. There are 18 teams competing in Denver's 28-and-over division and 17 teams in its 38-and-over division. Denver is the fourth-largest league affiliated with the National MSBL/MABL. Its 38-and-over division is also one of the largest of its kind in the national organization.

Tony was Denver's first President and remained in that office until the 1991 season. During that period, Tony, again working with Steve, helped MSBL affiliates get started in Ft. Collins and Colorado Springs. As a member of the Colorado Army National Guard, Panasuk was placed on alert for Desert Storm. Since he expected to ship out at any moment, Tony resigned as President. He didn't feel free to take an active role in the league again until after 1992, when he retired from the Guard.

At the conclusion of the 2001 season, Tony decided he would like to be President of the Denver MSBL again. He put his name forward



CaP CURE DONATIONS 2003 as of 10/2/03

NAME OF LEAGUE/PERSON	STATE	DATE REC'D	AMOUNT	PRESIDENT
Atlanta MABL 18 +	GA	2/3/03	\$100	Steve Rosenberg
Atlanta MSBL 28 +	GA	2/3/03	\$100	Steve Rosenberg
Austin MSBL	TX	1/28/03	\$100	Michael Lucas
Austin MABL	TX	6/20/03	\$261	Michael Lucas
Beaver County MSBL	PA	3/3/03	\$100	Chris Caputo
Bux Mont MSBL	PA	3/13/03	\$100	Jeff Misialek
Central Coast MSBL 28 +	CA	2/1/03	\$100	Mike Jennings
Central North Carolina MSBL	NC	4/14/03	\$360	Glenn Garrison
Central Ohio MABL	OH	4/3/03	\$100	Charles McCroskey
Chesapeake MSBL	MD	3/31/03	\$100	Garry Gladden
Chicago Central Suburban	IL	1/15/03	\$100	Jack Pohlmeier
Delaware County MSBL	PA	2/20/03	\$100	Dan McNeely
Detroit MSBL	MI	12/31/02	\$100	Mike Juliano
Dodgertown West MSBL	CA	1/2/03	\$200	Joe Mousser
Fresno MABL	CA	3/4/03	\$100	Andrew Crouch
Fresno MSBL	CA	10/2/02	\$100	Andrew Crouch
Gold Country	CA	6/6/03	\$150	David Kelley
Greater Philadelphia MABL	PA	1/7/03	\$100	Brett Mandel
Jacksonville MSBL	FL	3/3/03	\$100	Norm D'Accardi
Kansas City MSBL/Wm.Hutton	KS	5/24/02	\$15	Tom Prendergast
Lehigh Valley MSBL	PA	2/23/03	\$100	Turk Starniri
Long Island MSBL	NY	3/3/03	\$11,000	Steve Sigler
Long Island Midweek MSBL	NY	1/29/03	\$500	Tim Hott
Louisville MSBL	KY	4/26/03	\$150	D.C. Frank
Memphis MSBL	TN	4/11/03	\$150	Troy Secrist
Mid-Iowa MSBL	IA	4/6/03	\$300	Tim Kirgan
Middle Tennessee MABL	TN	4/21/03	\$100	Bart Leathers
Midwest Suburban MSBL	IL	3/25/03	\$200	Larry Kolcz
New Mexico MSBL	NM		\$100	
Northern Illinois MSBL	IL	1/29/03	\$200	John Reincke
Northwest Arkansas	AR	6/25/03	\$150	Stephen Boudreaux
Omaha MSBL	NE	2/13/03	\$100	Bobby Suggs
Quad County MSBL	WA	5/12/03	\$100	Mike Aguilar
Rochester MSBL	NY	5/11/03	\$100	Vern VanSkiver
So Cal MSBL 28 +/38 +	CA	2/14/03	\$250	Dennis Swartout
So Cal MABL 18 +	CA	2/14/03	\$250	Dennis Swartout
Sonoma County MABL/MSBL	CA	4/10/03	\$200	Rick Cantor
Southeast Minnesota MSBL/ Jay Goetting	MN	9/9/03	\$300	Al Begin
Stanislaus MSBL	CA	2/10/03	\$100	Ron Graves
Susquehanna Valley MSBL	PA	4/19/03	\$100	Jeff McGaw
Sun Valley MABL	ID	7/16/03	\$100	Curtis Bacca
Syracuse MSBL	NY	3/18/03	\$150	Jim Maturo
Tri-Valley MSBL	CA	4/18/03	\$200	Mike Protheroe
Twin City MSBL	MN	5/12/03	\$100	Jon Garbacz
Vermont North MSBL	VT	6/30/03	\$150	Mike Wagner
Westchester MSBL	NY	6/2/03	\$100	James Bianco
West Jersey MSBL 48 +	NJ	4/18/03	\$100	Bill Curzie
Woodland Davis MSBL	CA	6/3/03	\$200	Gerri Stonebrook
Total as of 10/2/03			\$18,036	

CaPCURE is a foundation established to find a cure for prostate cancer. Individuals, teams or leagues wishing to donate can make checks payable to "CaPCURE" and mail to MSBL, One Huntington Quadrangle, Suite 3N07, Melville, NY 11747.

Board of Directors

Michael Milken
Chairman

Merv Adelson
Chairman
East West Venture Group

James Blair
General Partner
Domain Associates

Helene Brown
Director Community
Applications of Research
UCLA

S. Ward (Trip) Casscells III, M.D.
John Edward Tyson Distinguished
Professor of Medicine and Vice
President of Biotechnology
University of Texas HSC, Houston

David Ederer
Chairman
Ederer Investment Company

Sue Gin
Chairman and Chief
Executive Officer
Flying Food Group, Inc.

The Reverend Rosey Grier
The Milken Family Foundation

Andrew Grove
Chairman
Intel Corporation

Stuart Holden, M.D.
Director, Warschaw Prostate
Cancer Center
Warschaw, Robertson,
Law Families Chair
in Prostate Cancer
Cedars-Sinai Medical Center

David Koch
Executive Vice President
Koch Industries

Earle Mack
Senior Partner
The Mack Company

Shmuel Meitar
Director
Aurec Group

Lori Milken
Vice President
Prostate Cancer Foundation

Nelson Peltz
Chairman and Chief
Executive Officer
Triarc Companies, Inc.

Lynda Resnick
Vice Chairman
Roll International

Bert Roberts
Consultant

Richard Sandler
Partner, Maron and Sandler
Executive Vice President
The Milken Family Foundation

Lorraine Spurge
Managing Director
Metropolitan West Financial

Michael Tarnopol
Vice Chairman
Bear, Stearns & Co. Inc.

Robert Voss
President
Fox Packaging Company

Jerry Weintraub
President
Jerry Weintraub Productions

Elaine Wynn
Co-Chief Executive Officer
Wynn Resorts

Stanley Zax
Chairman and President
Zenith National Insurance Corporation



**Prostate
Cancer
Foundation**

Leslie Michelson
Vice Chairman & CEO

October 3, 2003

Men's Senior Baseball League, Inc.
One Huntington Quad 3, No. 7
Melville, NY 11747

Dear Sir/Madam,

It is our great pleasure to enclose the CaP CURE 2002 Annual Report. As you can see, the report features people whose lives have been changed by this disease and those who have changed the course of this disease. On the cover and throughout the report, you will find photos of patients, physicians, scientists, supporters, and family members who are battling to defeat prostate cancer. Working together, we are confident we will succeed.

You will see our new name and logo proudly displayed on the front and back covers and incorporated in the text. Our mission remains unchanged: find better treatments and a cure for prostate cancer. Now, however, the time has come to harness more of our society's resources to fight this deadly disease. Our new name and image will help us get our messages out to more people:

- Prostate cancer is the most common non-skin cancer in America, striking more than 220,000 men per year.
- Of all of the cancers, prostate cancer will have the largest increase in incidence over the next ten years as the baby boomer men reach the target zone for prostate cancer, beginning at age 50.
- Of all of the major cancers, prostate cancer has the strongest familial link.
- The Prostate Cancer Foundation is focused on one thing: finding better treatments. We invest \$0.78 of every dollar we raise in the most promising research projects, in contrast to the other major health care philanthropies, who invest an average of \$0.22 per dollar in research.
- We are making great progress. Treatments are now better than ever and there are 50% more prostate cancer drugs under development than there were just five years ago. Many of these are the result of PCF-funded research.

Thus, while the need is greater than ever, so are the opportunities.

Our pride in our accomplishments is exceeded only by our gratitude to you for your ongoing support and our commitment to our mission. Please accept our deepest appreciation for your generosity and our hope that you continue to help us in the fight of our lives.

Best regards.

Very truly yours,

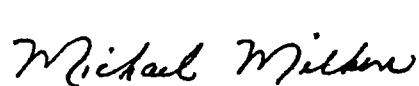

Michael Milken
Founder and Chairman

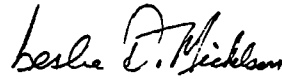

Leslie D. Michelson
Vice Chairman and Chief Executive Officer

DETAILED LIST OF BENEFITS

National Insurance Programs

MSBL/MABL National will offer two alternate policies, a general liability policy without medical coverage for \$95 per team and a liability/comprehensive medical policy for \$153 per team. Each league can still have the 2 million-dollar liability policy, along with a \$25,000 medical policy for their players. So now each player will be covered medically during local league play, regional and national tournaments for up to \$25,000. The policy can act as either primary or secondary coverage.

Tournament Participation

World Series/Fall Classic

By becoming an affiliated member of the Men's Senior Baseball League or Men's Adult Baseball League, your league can enter a Father/Son, 18+, 28+, 38+, 48+, 58+ or 65+ team in our annual World Series held in Arizona or the Fall Classic in Florida. In 2003, MSBL/MABL hosted 476 teams, including teams from Canada, Venezuela, Australia and the Virgin Islands, participating in "A", "B", "C", "D" and "E" classifications. The tournament also offers metal and wood bat divisions. The tournaments are a culmination of what MSBL/MABL stands for and brings together the majority of our leagues in an excellent display of competition and camaraderie.

Holiday Classic at Disney / Desert Classic / Las Vegas Kickoff Classic / Cactus Classic / Las Vegas Open

The Holiday Classic at Disney occurs over Martin Luther King Jr. weekend and has 18+, 28+ and 38+ classifications. Played primarily on the Atlanta Braves Spring training facilities, it is fast becoming one of the most popular MSBL/MABL tournaments.

A MSBL/MABL staple tournament will now become one of the elite national tournaments in the country. Held over two successive weekends in March, the Kickoff Classic in Las Vegas will again host over 80 teams in 18+, 28+, 38+ and 48+ age divisions.

New for 2004 is the MSBL/MABL Desert Classic, also over Martin Luther King Jr. Weekend. With a golf tournament and the beautiful weather and scenery that Palm Springs provides, this tournament is a perfect fit for our West Coast teams.

The Cactus Classic in Phoenix, AZ is a strong addition to the line-up of national tournaments offered through MSBL/MABL. This tournament, held in late March, caters to the baseball enthusiasts who want to combine their tour-

ament play with seeing MLB Spring Training. This tournament will host 28+, 38+ and 48+ age divisions.

Over Memorial Day, the Las Vegas Open will host over 70 teams. Taking place where the weather is always perfect and the fields are even better, this tournament continues to be the premier Memorial Day tournament in the country, offering wood bat divisions as an option.

Regional Tournaments

In addition to our national tournaments, MSBL sponsors 30 regional events per year. These weekend (Friday, Saturday, Sunday) games bring together leagues in close geographic proximity and emphasize "regular season teams" so everyone can have the opportunity to experience tournament play. Our regionals have been successful and also provide "hosting" cities with much publicity. The national organization helps sponsor each regional event by donating over \$1,700.00 in product and cash.

Below please find a list of MSBL sponsored merchandise each regional tournament will be provided with for awards, promotion, etc.

- 5 dozen baseballs
- 2 Easton bats
- 15 pairs of Easton batting gloves
- \$335.00 cash allocation
- \$500.00 of Rawlings merchandise

Sponsor Derived Benefits

Anaconda Sports

MSBL/MABL is proud to announce the continuation of a multi-year agreement with Anaconda Sports, one of the nation's largest sporting goods suppliers. Each member will be able to see the benefits of this agreement with special discounts offered to MSBL/MABL members through bi-weekly emails. In addition, each manager will receive the full 80+ page Anaconda catalog from which MSBL/MABL members may order merchandise. The full catalog will also be accessible from the MSBL Sports Store online.

MSBL/MABL Sports Store

Call 877-HIT-MSBL (877-448-6725) at Anaconda Sports to receive the guaranteed lowest price on catalog sporting goods (restrictions apply on Rawlings baseballs) or check out our website at www.msblsportsstore.com to view the Sports Store and monthly specials offered.

Membership Card/Product Catalog

MSBL/MABL members receive directly, their own individual league membership card and product catalog. The catalog features various sporting goods companies such as Rawlings, Easton, Ringor, and official MSBL/MABL outerwear products. The membership card provides a direct 800-telephone number for ordering catalog merchandise at substantial savings.

Travel Discounts

Avis Rent-A-Car

Every MSBL/MABL member is guaranteed Avis' lowest rate on full and mid-size cars. Call Avis at 1-800-331-1212 and refer to AWD code #B745000.



MSBL/MABL Baseballs

Our most popular ball, the raised-seam R-100 is now named the RMSBL. By introducing this new RMSBL ball, we can offer the ball for \$5 less per dozen. Also, if a league orders 100 dozen or more, Rawlings will put the individual league logo on the ball at no extra cost!

2004 Styles/Price*

RMSBL \$39.96

***Free Freight with orders of 20dz or more**

***Free MSBL/MABL ball bucket with orders of 100dz or more**

Hardball Magazine

1991 brought the introduction of the MSBL magazine, Hardball, which highlights stories on all our leagues, national tournaments, regional tournaments, etc. Hardball includes a "Tips From the Pros" column and features articles written by sports doctors for baseball related injuries and prevention. The magazine is now published five times annually and mailed directly to each member's home. The fifth issue is solely dedicated to local league coverage.

Promotional Tape

MSBL/MABL offers a 5-minute professional promo tape narrated by Mel Allen. This is a combined informative and promotional video. Each league will be allocated one tape, and additional tapes may be ordered. The tape can be used for sponsorship proposals, organizational meetings and/or media solicitations.

Sponsorship Support

MSBL National can help support local leagues in their sponsorship solicitations by providing, on request, a full media package, sample sponsor letter and sponsorship summary kit. In addition, "national" affiliation often helps bring credibility to sponsor presentations.

MSBL/MABL Scorebook

MSBL had developed its own 25-game scorebook, which is delivered to all teams at no charge annually.

MSBL/MABL Brochure & Poster

These brochures provide basic background and benefit information and are excellent sources for player information. The MSBL/MABL National poster can be used to advertise your local league. It, too, outlines membership benefits and includes a business card holder for local league contact information.

Scorebook.com

The official online program of MSBL/MABL National, Scorebook.com offers everything a local league needs to efficiently run their league. Team Rosters, Game Schedules and Results, Player Profiles, Stats and Field Locations (with Driving Directions) all have a place in Scorebook, and new features will be added in the near future. And when the season is over, lock it and come back next year. Contact Jeff at Scorebook.com for more information, 201-327-8746 x124.

National Sponsors

In addition to all the benefits MSBL/MABL provides, we have also entered into multi-year agreements with Rawlings, Ringor and Easton Sports. These sponsorship agreements aid in MSBL/MABL's ability to sponsor regional and national tournaments and pass along valuable savings to our members.

National Rules

The MSBL/MABL National office provides league rules that have been based on years of use and modification to make them suitable for our players. All rules (tournament and national) can be found on the MSBL web site and in every scorebook.

MSBL Internet Website

MSBL has developed its own website. Visit us at msblnational.com for information about the league, tournaments, and other news. We also have an on-line, secure MSBL Sports Store, where all types of sporting goods and equipment can be purchased over the internet. You can e-mail us at info@msblnational.com.

MSBL/MABL MasterCard

The official MSBL/MABL MasterCard offers benefits such as no annual fee, complimentary additional cards, and low interest percentage rate.

To apply, please call 800-523-7666 and reference #JDBN.

Discounted Auto and Home Insurance

MSBL/MABL members can enjoy discounts on home and auto insurance from Liberty Mutual. Existing customers of Liberty Mutual are eligible to receive this group discount and new members are entitled to a free quote. To find out more call 1-800-225-8281 and refer to code #9080.

MEN'S SENIOR BASEBALL LEAGUE / MEN'S ADULT BASEBALL LEAGUE 2001 ACCIDENT AND MEDICAL COVERAGE

WHAT IS A COVERED ACTIVITY?

Any injury sustained from participating in a sanctioned game or practice. All Players, Managers, Coaches and Batboys are eligible. **UMPIRES ARE NOT COVERED UNDER THIS POLICY.**

WHAT ARE THE LIMITS?

\$15,000..... EXCESS MEDICAL EXPENSES
\$5,000..... DEATH AND DISMEMBERMENT
\$1,000..... DENTAL (\$200 PER TOOTH)
\$150..... DEDUCTIBLE
THERAPY VISITS ARE LIMITED TO 3 VISITS - \$50 PER VISIT
CHIROPRACTOR VISITS ARE LIMITED TO 3 VISITS - \$50 PER VISIT

CLAIMS THAT HAVE NO PRIMARY INSURANCE ARE PAID ON AN 80/20 BASIS

WHAT IS AN ELIGIBLE EXPENSES?

If the Insured's injuries result in expenses shown below, the company will pay for the "Necessary" medical treatment up to the "Usual" and "Customary" charges for such expense incurred within fifty-two weeks from the date of the accident. Treatment must begin within sixty days of the date of the accident.

- Medical and surgical care by a physician
- Medical services in a hospital
- X-rays and lab tests
- Ambulance within forty-eight hours of the covered accident
- Casts/, splints, crutches and braces (other than dental braces)
- Blood or plasma
- Drugs and medicines

WHAT ARE THE EXCLUSIONS AND LIMITATIONS?

This Plan does not cover any loss contribution to or resulting from: sickness or disease of any form, the use of drugs or narcotics, suicide, war or any act of war, riding as a passenger or otherwise in any flying device, or serving in one of the armed forces. Also excluded from the policy are Hernia's, however caused, experimental procedures, cosmetic surgery or procedures, hospital room and board charges in excess of the semi-private room rate unless hospitalized in a intensive care unit, any medical expense covered under workers compensation or mandatory no fault automobile insurance.

WHEN DOES THE COVERAGE GO INTO EFFECT?

The coverage will go into effect on the day your payment and roster is received in the office of Gagliardi Brothers Insurance through January 1, 2002. Any claims made prior to receiving payment and roster will be denied.

WHAT DOES IT COST?

We will contact each League President directly on pricing structure.

Premium is fully earned at inception of policy. No refunds will be given on Medical Policy.

HOW DO WE OBTAIN THIS INSURANCE?

Please send full premium and rosters directly to the offices of Gagliardi Bothers Insurance. Include on the rosters your League Name, Team Name, Name and address of each player. It is imperative that the League Name on your Medical Application is the same name as on your Liability Application.

HOW DO I FILE A CLAIM?

Upon receipt of your premium and roster you will be sent a packet of claims forms with filing instructions.

DOES IT MATTER IF I AM AN MSBL OR MABL LEAGUE WHEN FILLING OUT APPLICATION?

Yes!!!! You must put either MSBL or MABL on your Liability and Medical Information. All Liability and Medical Insurance Requests will be Rejected if they are received in the offices of Gagliardi Brothers showing MSBL/MABL as a league.

WHAT IF OUR LEAGUE HAS TWO DIFFERENT NAMES?

Your Liability and Medical applications must have the same name. When calling the offices of Gagliardi Brothers Insurance, you must refer to the name of the League that is on your application. Please do not use Nicknames or Pet names when calling on status of claims or certificates. Your league is filed under the name that is on your application.

WHERE DO I SEND THE LIABILITY APPLICATION?

All Liability applications are to be sent to the Men's Senior Baseball League National Headquarters, with the appropriate premium payment. The address is:

MEN'S SENIOR BASEBALL
ONE HUNTINGTON QUADRANGLE, STE 3 No 7
MELVILLE, NY 11747

PLEASE NOTE, ALL REQUESTS FOR LIABILITY CERTIFICATES MUST COME FROM THE NATIONAL OFFICES. GAGLIARDI BROTHERS INSURANCE WILL NOT TAKE ANY ORDERS DIRECTLY.

WHERE DO I SEND THE MEDICAL PREMIUM AND ROSTERS?

All rosters and Accident Insurance premium can be sent directly to:

GAGLIARDI BROTHERS INSURANCE
GAGLIARDI INSURANCE SERVICES, INC.
2380 SOUTH BASCOM AVE. SUITE 200
CAMPBELL, CA 95008
PHONE: (408) 369-8040 • FAX: (408) 377-5348

FOR EXAMPLE:

LIABILITY

**COST IS \$85 PER TEAM FOR THE \$1,000,000 COVERAGE
#OF TEAMS X \$85 TO BE REMITTED TO THE MSBL/MABL
NATIONAL HEADQUARTERS WITH A COMPLETED APPLICATION**

MEDICAL

**IF ANY TEAM IN YOUR LEAGUE WISHES TO
PURCHASE MEDICAL THEY CAN, HOWEVER
A FULL ROSTER AS DESCRIBED ABOVE WITH
FULL PAYMENT MUST BE SUBMITTED
DIRECTLY TO GAGLIARDI BROS. INS.**

MEN'S SENIOR BASEBALL LEAGUE / MEN'S ADULT BASEBALL LEAGUE 2001 GENERAL LIABILITY AND ACCIDENT INSURANCE PROGRAM

WHAT COVERAGE IS OFFERED?

LEGAL LIABILITY COVERAGE: This policy provides coverage for damages you are legally obligated to pay because of bodily injury or property damage caused by an occurrence. The covered activities are any duly sanctioned baseball events of Men's Senior Baseball and Men's Adult Baseball Leagues. This includes practices, regular and/or exhibition games. The policy applies to the following incidents:

- Spectator Injury
- Property Damage
- Host Liquor Liability
- Injury or Death of Participants
- Incidental Medical Malpractice
- Cost of Investigation and defense of claims
- Injury or Death of Adult Volunteers

WHAT ARE THE LIMITS OF LIABILITY?

\$1,000,000..... EACH OCCURRENCE FORM
\$2,000,000..... GENERAL AGGREGATE (PER LOCATION)
\$1,000,000..... PRODUCTS & COMPLETED ADVERTISING
\$50,000..... FIRE DAMAGE
\$2,500..... MEDICAL EXPENSE
\$500,000..... PARTICIPANT LEGAL LIABILITY - PARTICIPANT LEGAL LIABILITY IS NOT AN ACCIDENT COVERAGE
\$0..... DEDUCTIBLE

PARTICIPANTS INCLUDE PLAYERS, COACHES, MANAGERS, STAFF MEMBERS, AND OFFICIALS. DAMAGE TO PARTICIPANTS PROPERTY IS EXCLUDED

WHAT ABOUT ADDITIONAL INSURED?

If a team is required to name an "owner" or "operator" of the ball field as an Additional Insured, Gagliardi Brothers Insurance will issue an Additional Insured Certificate at no additional cost. Simply complete the Additional Insured portion of the application.

WHAT IF I ACQUIRE NEW FIELDS AFTER I HAVE SENT IN MY LIABILITY APPLICATIONS?

Just simply make a copy of the original application form and fill it out along with the additional field information. Fax or mail the information to the National Headquarters offices of the Men's Senior Baseball and Men's Adult Baseball Leagues.

WHAT IS EXCLUDED?

Asbestos, Pollution, Nuclear Inter Company Products Suits, Professional Liability, Assault & Battery, Damage to Spectators or Participants Vehicles, Fireworks, Collapse of Temporary Structure, Designated Work, Broad Form Securities, Fields of Entertainment, Stunts, Employment Related Practices.

WHAT DOES IT COST?

The cost of the Liability Insurance is \$85.00 per team.

ONCE CERTIFICATES OF INSURANCE ARE ISSUED, LIABILITY PREMIUM WILL ONLY BE REFUNDED ON A PRO RATA BASIS.

HOW ARE LIABILITY CLAIMS FILED?

Each insured team having a claim must contact Teresa at Gagliardi Brothers Insurance - (408) 369-8040 - immediately when notice is received that an individual is making a claim against your team/league. Gagliardi Brothers Insurance will provide you with a claim form and advise you as to the requirements in processing your claim.

**MEN'S SENIOR BASEBALL LEAGUE
NOTICE OF LIABILITY CLAIM**

LEAGUE NAME: _____

ADDRESS: _____

CITY, STATE & ZIP: _____

PERSON TO CONTACT: _____ PHONE NUMBER: _____

DATE OF OCCURRENCE: _____

LOCATION OF OCCURRENCE (INCLUDE CITY & STATE): _____

DESCRIPTION OF OCCURRENCE: _____

NAME OF CLAIMANT (INCLUDE ADDRESS): _____ PHONE NUMBER: _____

IS CLAIMANT A PLAYER, SPECTATOR, COACH, MANAGER, OR UMPIRE? YES OR NO?

DESCRIBE INJURY: _____

DESCRIBE PROPERTY (TYPE, MODEL, ETC.): _____

WITNESSES (INCLUDE NAME, PHONE NO. & ADDRESS): _____

LEAGUE OFFICIAL SIGNATURE

***ALL LIABILITY CLAIMS MUST BE SUBMITTED BY THE LEAGUE. PLEASE FAX THIS SHEET
TO: TERESA @ (408) 377-5348 or Email to: teresa@gbinsurance.com**

GAGLIARDI BROTHERS INSURANCE
2380 SOUTH BASCOM AVE., SUITE 200
CAMPBELL, CA 95008
TEL: (408) 369-8040 FAX: (408) 377-5348